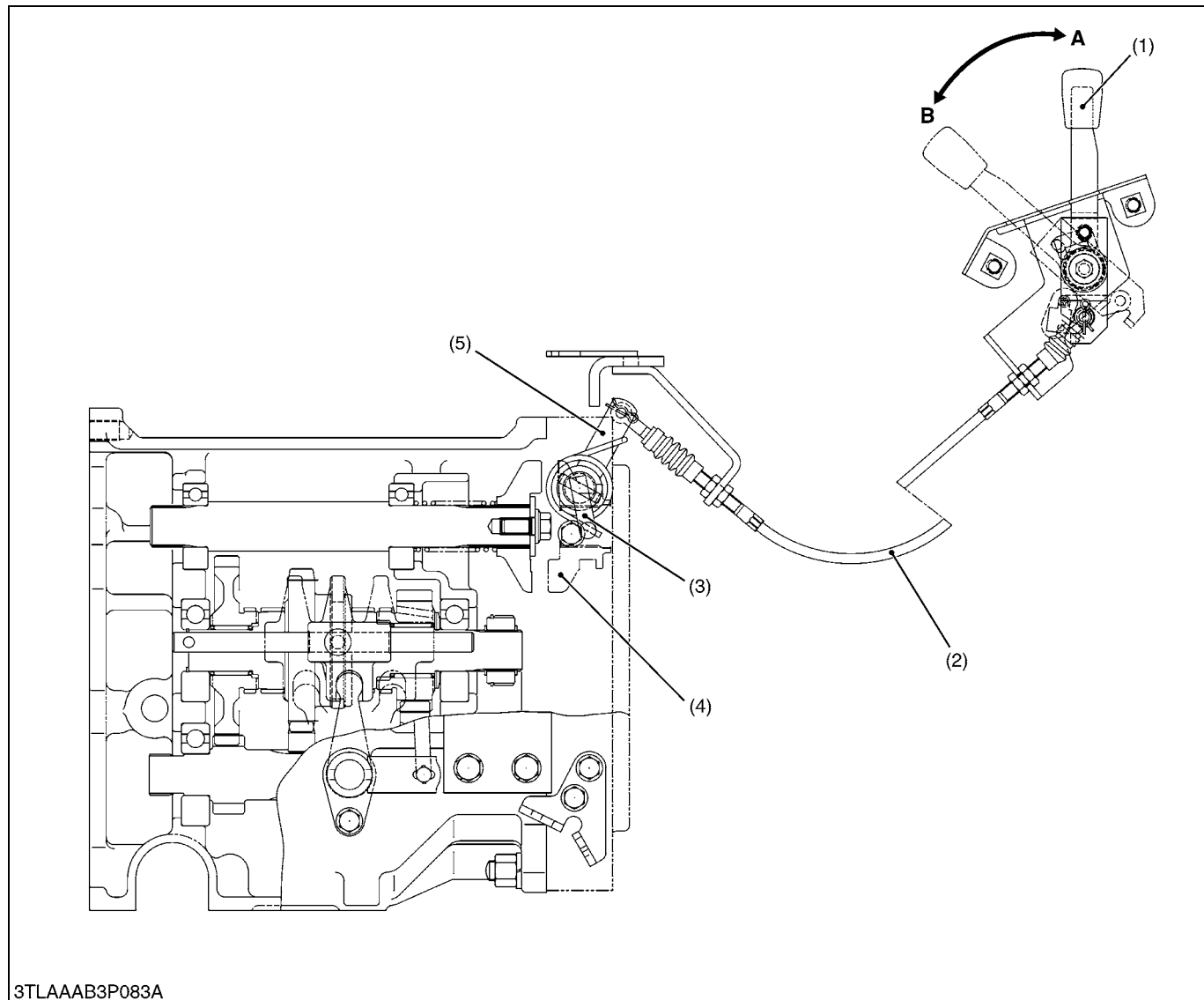

(2) Mechanism**[A] L3301/L3901****Shift Linkage**

(1) PTO Lever

(3) PTO Shift Fork

(5) Lever

A: Disengaged

(2) PTO Shift Cable

(4) 16T PTO Clutch

B: Engaged

The PTO lever (1) through the shift fork (3) are connected by shift cable (2), as shown in the figure above.

When the shift lever (1) is moved to the "A" side or the "B" side, the shift fork (3) is moved by means of the shift cable (2) and lever (5).

When the shift lever (1) is moved to the "A" side, the PTO is shifted to the "**Disengaged**" position.

When the shift lever (1) is moved to the "B" side, the PTO is shifted to the "**Engaged**" position.

9Y1211012TRM0039US0