

### Disassembling Steering Clutch

1. Remove the internal snap ring (1).
2. Remove the clutch plate (2) and spline boss (5) with clutch disc and friction plate (3) from the steering clutch case (10).
3. Remove the spacer (7), spring (8) and clutch collar (9).
4. Remove the clutch disc and the friction plate (3), clutch spline (4) and external snap ring (6) from spline boss (5).

- |                                    |                           |
|------------------------------------|---------------------------|
| (1) Internal Snap Ring             | (6) External Snap Ring    |
| (2) Clutch Plate                   | (7) Spacer                |
| (3) Clutch Disc and Friction Plate | (8) Spring                |
| (4) Clutch Spline Plate            | (9) Clutch Collar         |
| (5) Spline Boss                    | (10) Steering Clutch Case |

W1080248

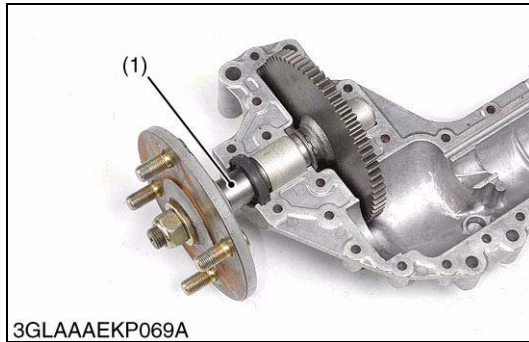

### Rear Axle

1. Remove the rear axle assembly (1) from the transaxle case.
2. Remove the bush (10) from 65T gear shaft (9).
3. Unscrew the lock nut (2), and remove the rear wheel hub (4).
4. Remove the oil seal (5), bush (6) and collar (7) and external snap ring (8) from 65T gear shaft (9).

#### (When reassembling)

- When installing the rear wheel hub (4) to the rear axle, apply the molybdenum disulphide (Three Bond 1901 or equivalent) to the splines of rear axle.
- Install the belleville washer (3), noting its direction as shown in the figure.
- When install the rear axle in the rear side of transaxle case (11), direct the splits **(A)** of bushes to the front side. Next, draw the bushes (6) (10) in the direction indicated by the arrow as shown in the figure.

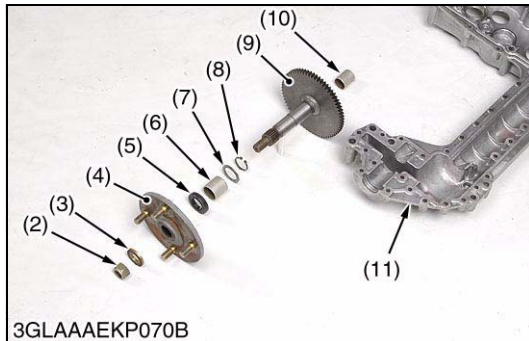

Tightening torque	Lock Nut	100 to 120 N·m 10.2 to 12.2 kgf·m 73.0 to 88.5 lbf·ft
-------------------	----------	---

- |                        |                                 |
|------------------------|---------------------------------|
| (1) Rear Axle Assembly | (7) Collar                      |
| (2) Lock Nut           | (8) External Snap Ring          |
| (3) Belleville Washer  | (9) 65T Gear Shaft              |
| (4) Rear Wheel Hub     | (10) Bush                       |
| (5) Oil Seal           | (11) Transaxle Case (Rear Side) |
| (6) Bush               | <b>A: Split of Bush</b>         |

W1080885

