

(1) 2-Hoses 1
2-Hoses 2

12. Interconnect the multi coupler 1 and multi coupler 2.

[Unlock]

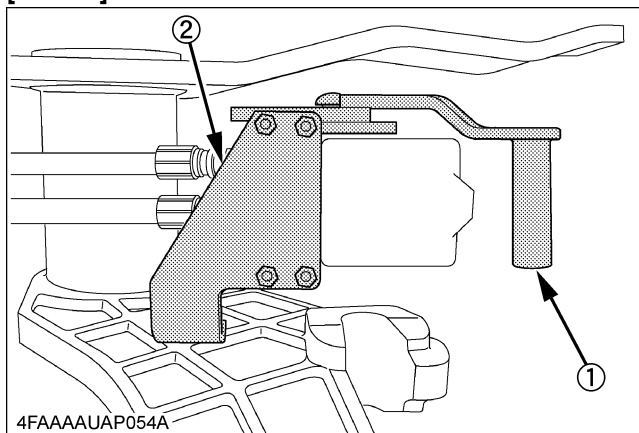

[Lock]

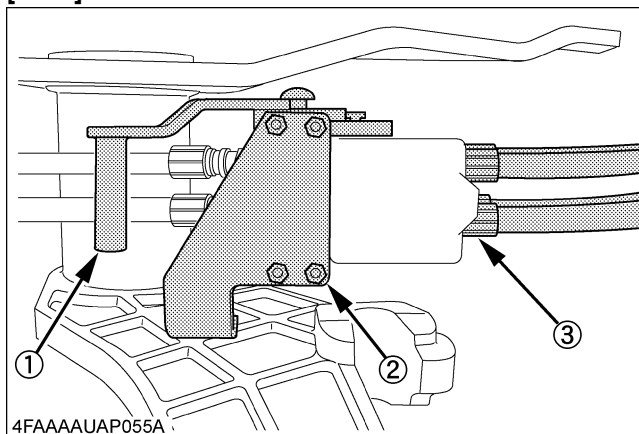

(1) Lever
(2) Multi coupler 1
(3) Multi coupler 2

■ 3rd Function (if equipped)

[M1867 (ROPS MODEL)]

[M1977 (CAB MODEL)]

1. Connect the hydraulic hose A-1 and hydraulic hose A-2 to the solenoid valve assembly.

[M1867 (ROPS MODEL)]

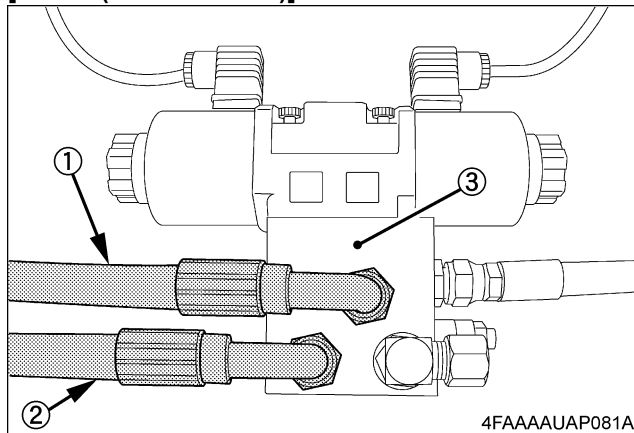

(1) Hydraulic hose A-1
(2) Hydraulic hose A-2

(3) Solenoid valve assy

[M1977 (CAB MODEL)]

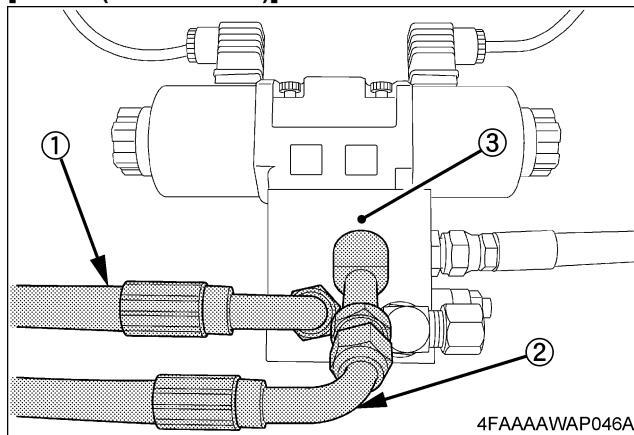

(1) Hydraulic hose A-1
(2) Hydraulic hose A-2

(3) Solenoid valve assy

2. Assemble the following parts as shown below.

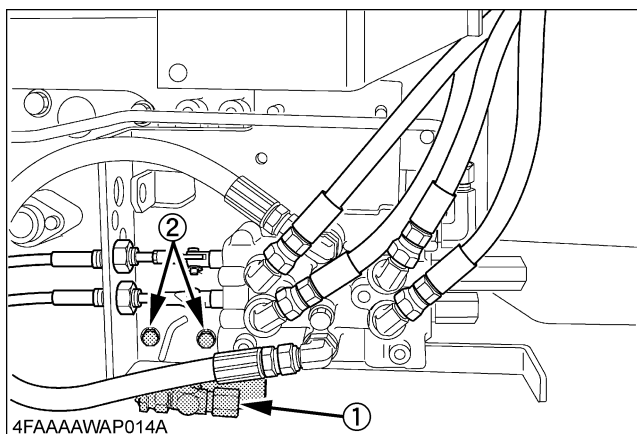

(1) Solenoid valve assy (2) 2-M10 x 30 bolts

3. Disconnect the pump line hose.
[Standard valve]

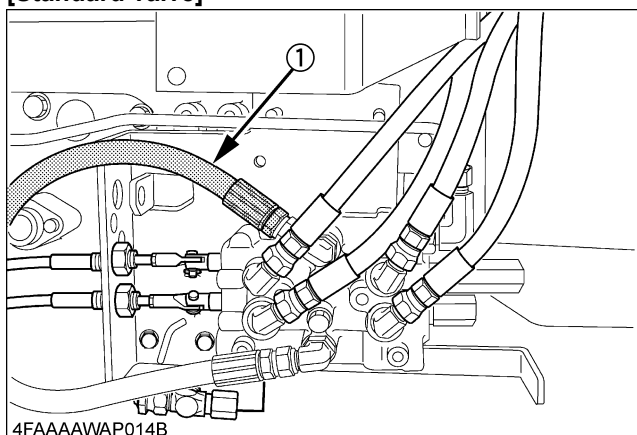

(1) Pump line hose

[Self-level valve (if equipped)]

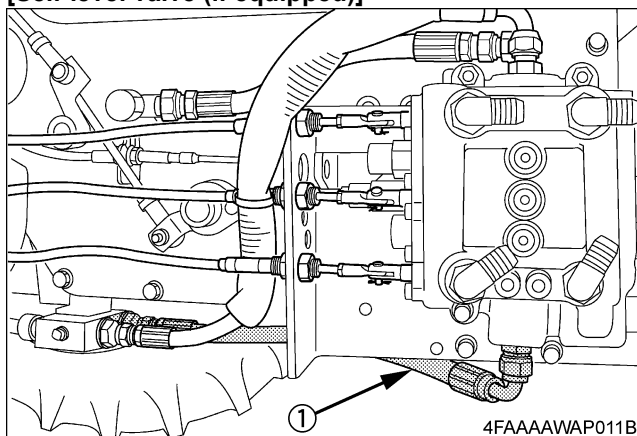

(1) Pump line hose

4. Assemble the following parts as shown below.

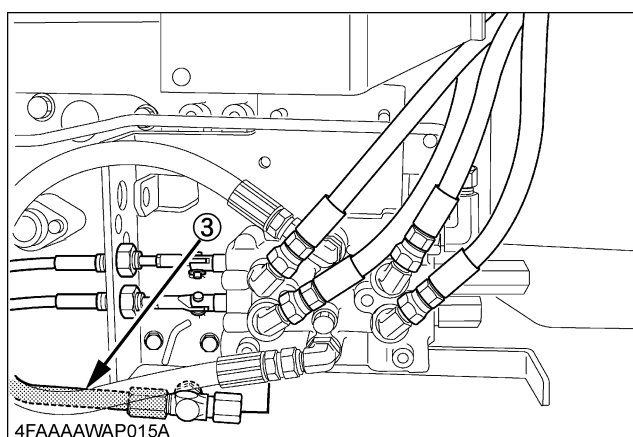
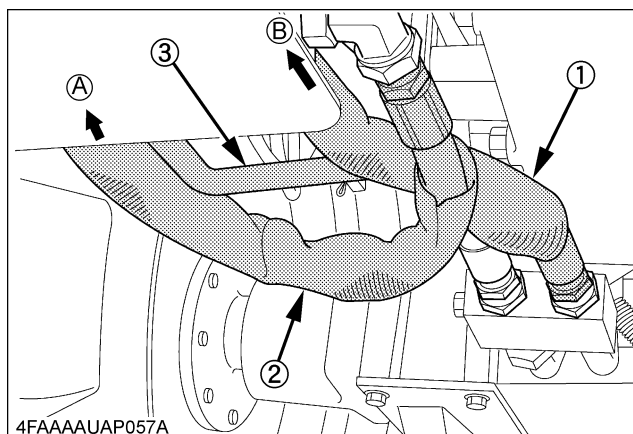

(1) Pump line hose 1 (A) To pump valve port
 (2) Pump line hose 2 (B) To solenoid
 (3) Tank tube

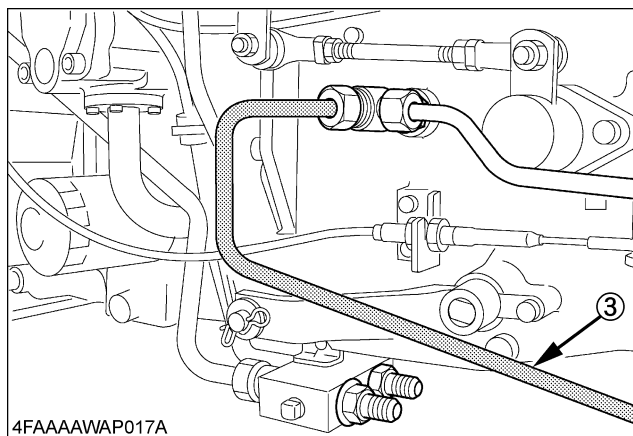

(3) Tank tube

5. Fit the coupler stay assembly as shown below.

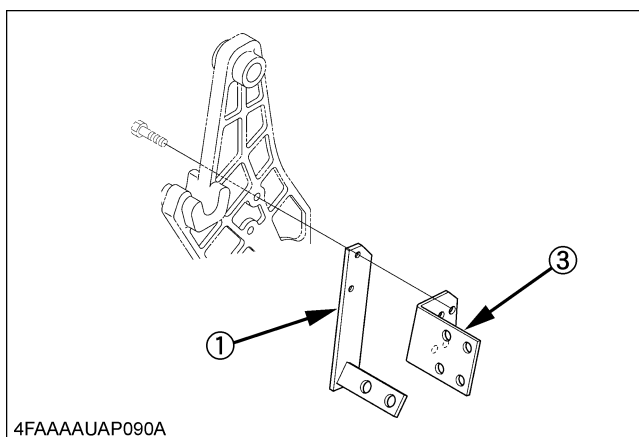
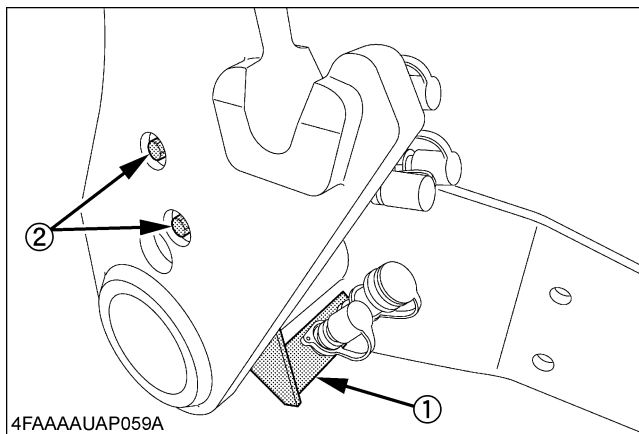

- (1) Coupler stay assy
- (2) 2-M10 x 50 bolts
- (3) Connector stay assy

[Multi coupler (if equipped)]

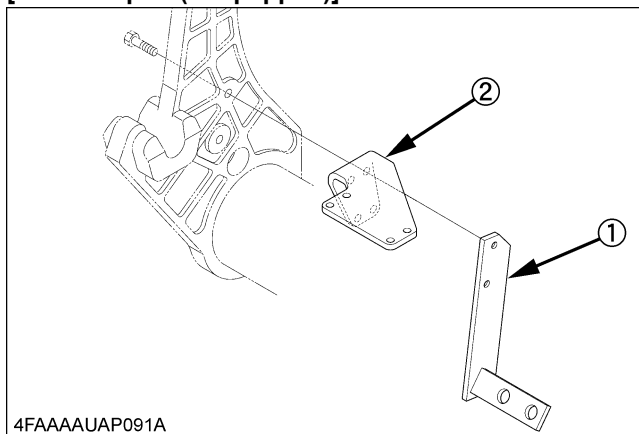

- (1) Coupler stay assy
- (2) Multi coupler stay assy

6. Connect Hydraulic hose A-1 and Hydraulic hose A-2 to coupler stay assembly.

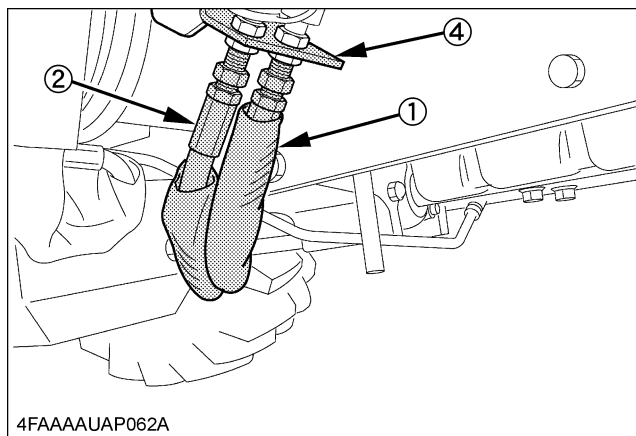
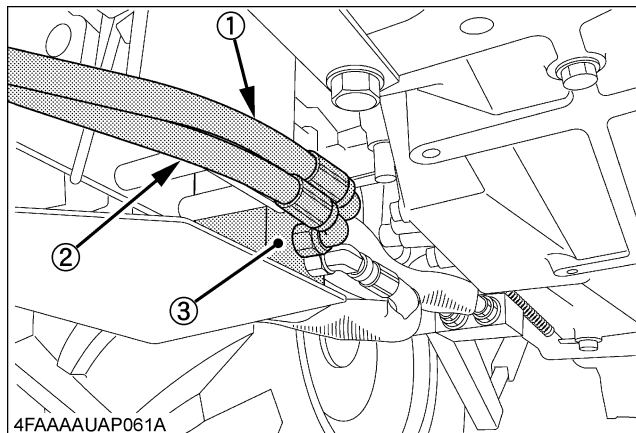

- (1) Hydraulic hose A-1
- (2) Hydraulic hose A-2
- (3) Solenoid valve assy
- (4) Coupler stay assy

7. Install tubes to the boom and install the hydraulic hoses to the tubes.

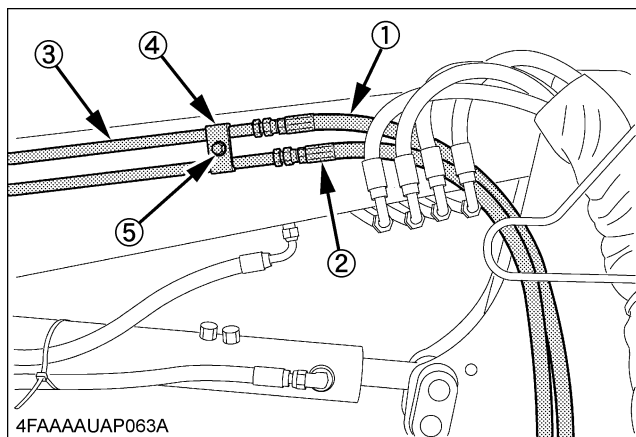

- (1) Hydraulic hose mid-1 (with nipple)
- (2) Hydraulic hose mid-2 (with coupler)
- (3) 2-Tubes
- (4) 2-Tube stays
- (5) 2-M8 x 35 bolts
- 2-Collars

8. Connect the hydraulic hoses to the coupler stay assy.

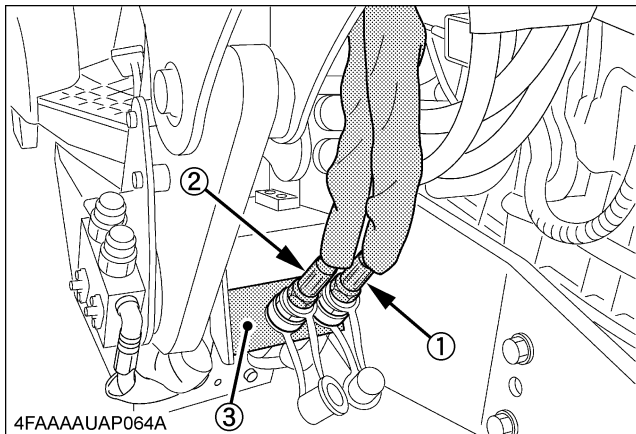

- (1) Hydraulic hose mid-1 (with nipple)
(2) Hydraulic hose mid-2 (with coupler)
(3) Coupler stay assy

9. Remove the M8 bolts from the cover.
Using the M8 bolts contained in the kit, secure the stay (provided with the hydraulic hose joint) and the cover together in position.
10. Connect the hydraulic hose hitch 1 and hydraulic hose hitch 2 between the pipe and hitch stay assembly.

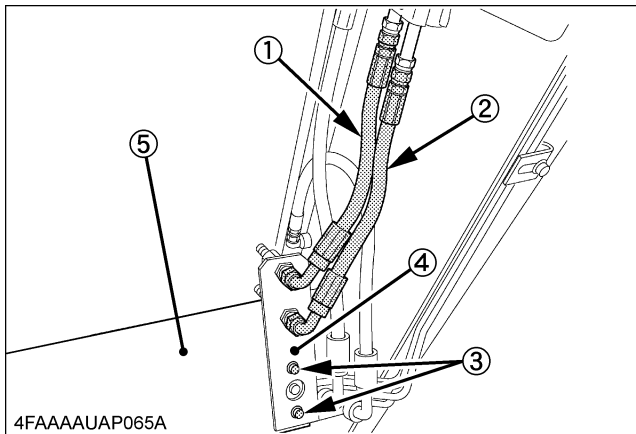

- (1) Hydraulic hose hitch-1
(2) hydraulic hose hitch-2
(3) 2-M8 x 40 bolts
(4) Stay
(5) Cover

Controller section

1. Remove the lever boot first and then the lever.

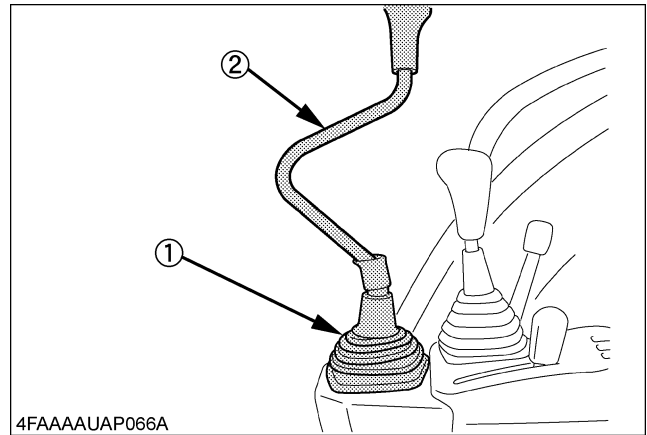

- (1) Lever boot
(2) Control lever

2. Cut the lever boot as shown below.

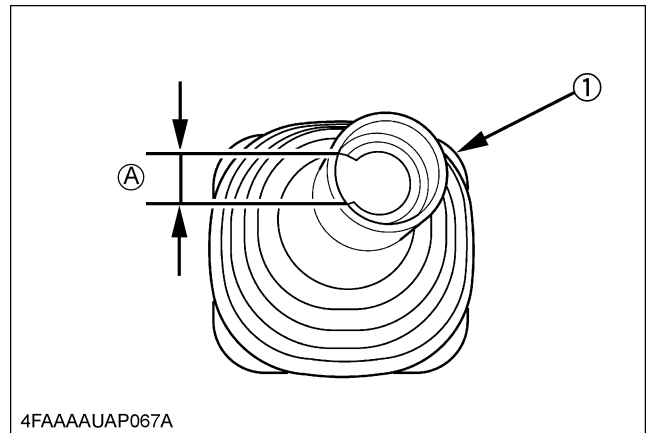

- (1) Lever boot
(A) 15 mm (0.6 in.)