

2. POWER TRAIN FOR TRAVELING GEAR

[1] SHUTTLE SHIFT SECTION

(1) Structure

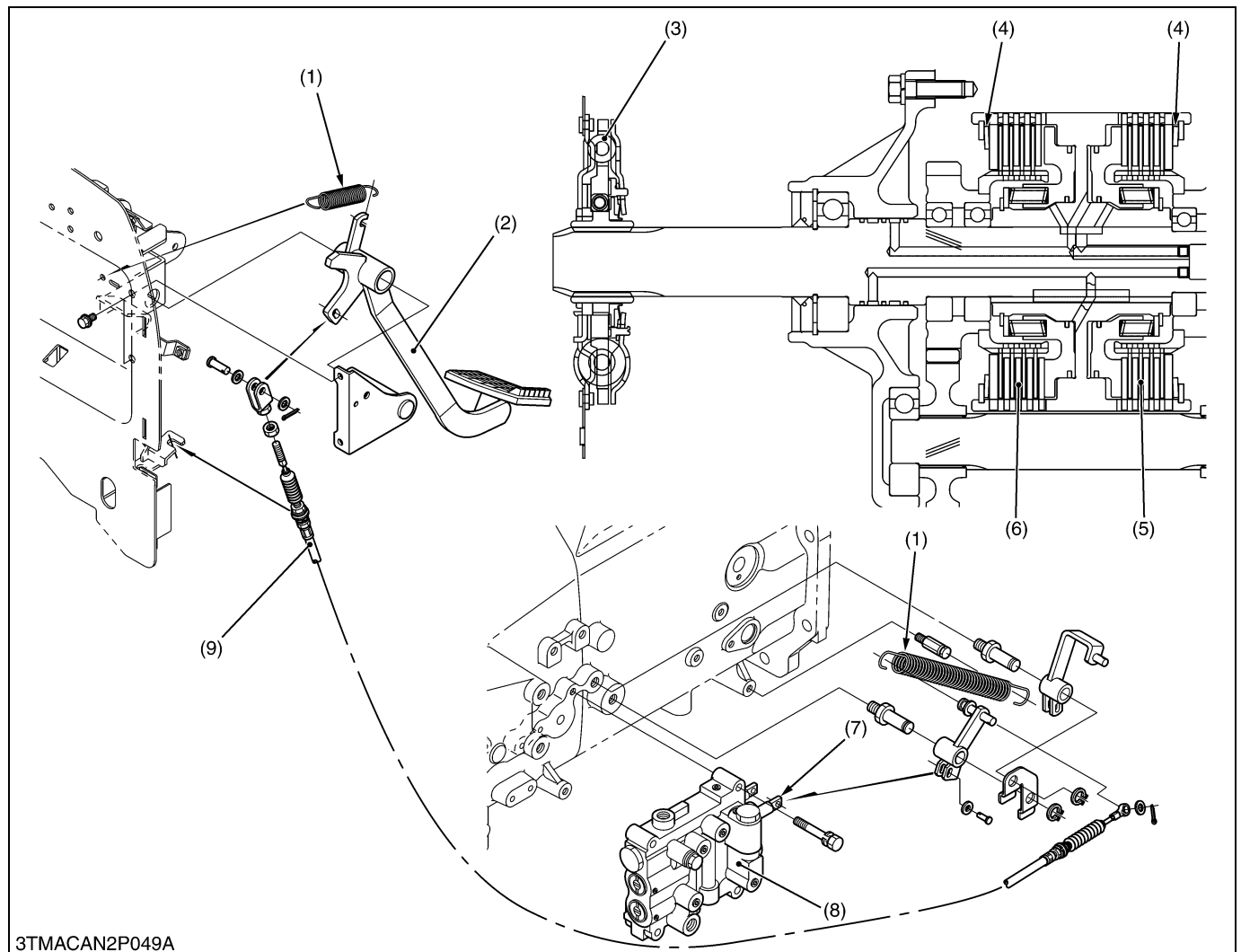

3TMACAN2P049A

- | | | | |
|-------------------|---|-------------------------|-----------------------------|
| (1) Return Spring | (4) Belleville Washer
(Cupped Spring Washer) | (6) Reverse Side Clutch | (8) Hydraulic Shuttle Valve |
| (2) Clutch Pedal | (5) Forward Side Clutch | (7) Clutch Spool | (9) Clutch Cable |
| (3) Damper Disc | | | |

The damper disc (3) helps ease the shock load when engaging the shuttle clutch.

The belleville washer (cupped spring washer) (4) helps ease the engaging shock together with modulating valve effect.

The hydraulic shuttle clutch, which switches forward and reverse running, function as the traveling clutch. When the clutch pedal (2) is depressed, the clutch spool of shuttle valve (8) moves via the clutch cable (9).

As for the oil, it does not flow to both the forward side (5) and reverse side (6) of the clutch pack, the clutch pack enters the state of "Disengaged" and power is not transmitted.