

■ 3rd Function (if equipped)

◆ Hydraulic Line Section

[Not equipped with backhoe]

Use the following kit parts as shown below.

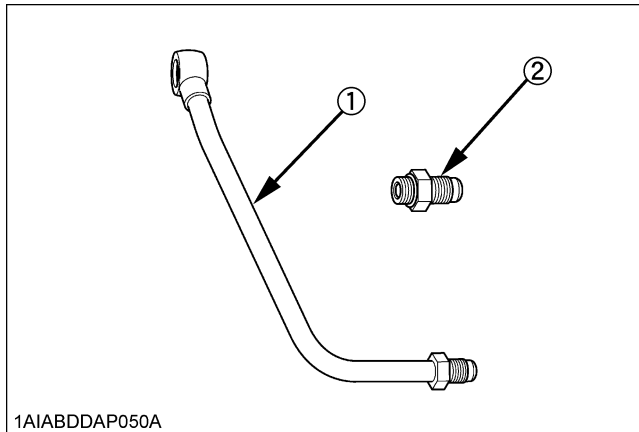

- (1) Power beyond pipe
(2) Adapter

1. Disconnect the front loader power beyond pipe.

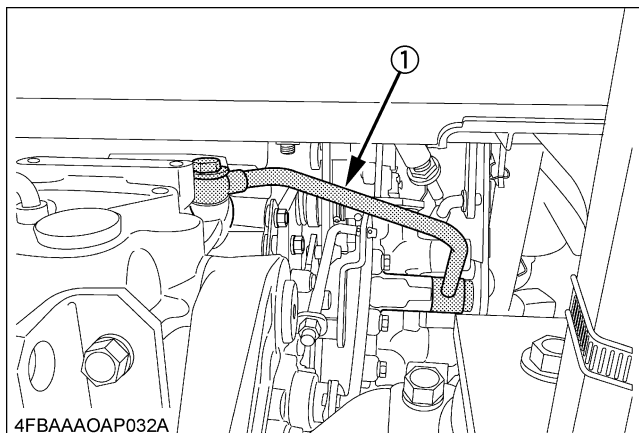

- (1) Front loader power beyond pipe

2. Connect the power beyond pipe and adapter as shown below.

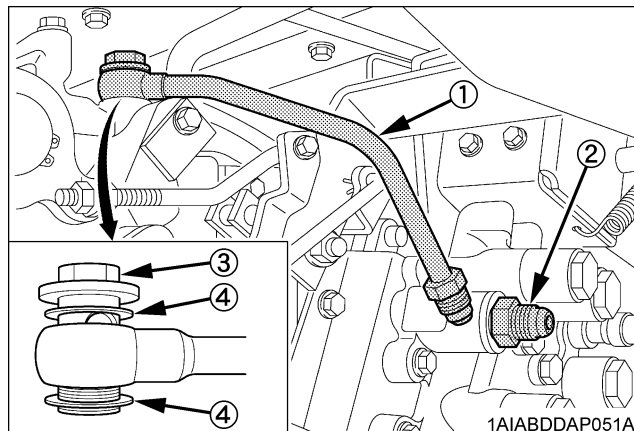

- (1) Power beyond pipe
(2) Adapter
(3) Plug (original)
(4) 2-Packing

NOTE :

- Tighten the plug (original) after all hoses are connected.

3. Connect the inlet hose to the adapter and connect the outlet hose to the power beyond pipe respectively.

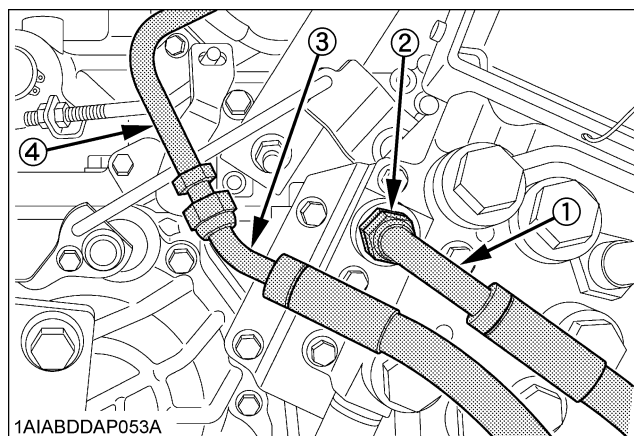

- (1) Inlet hose
(2) Adapter
(3) Outlet hose
(4) Power beyond pipe

4. Attach the 3rd function valve cover to the front loader main frame RH.

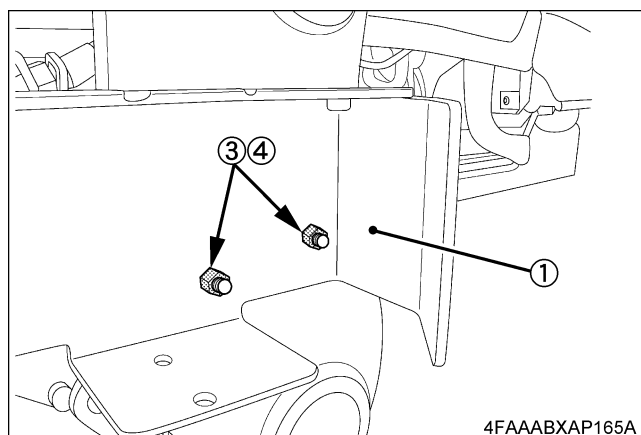
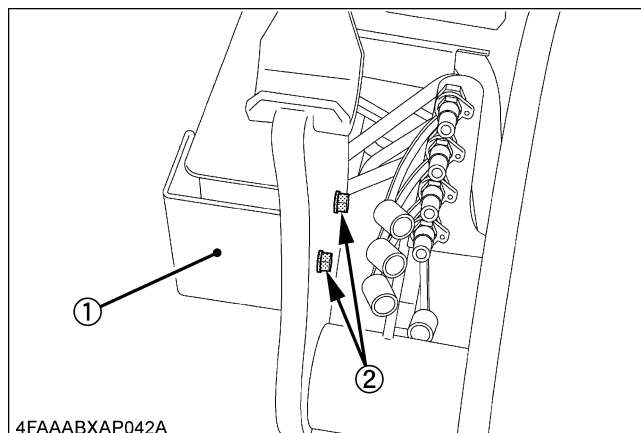

- (1) 3rd function valve cover
(2) 2-M10 x 40 bolts with washers
(3) 2-M10 spring lock washers
(4) 2-M10 nuts

Tightening torque	48.1 to 55.8 N·m (4.9 to 5.7 kgf·m) (35.5 to 41.2 lbf·ft)
-------------------	---

NOTE :

- Pay attention to the direction of the bolts.
(Apply them as shown in the figure.)

5. Install the 3rd function valve assembly on the 3rd function valve cover.

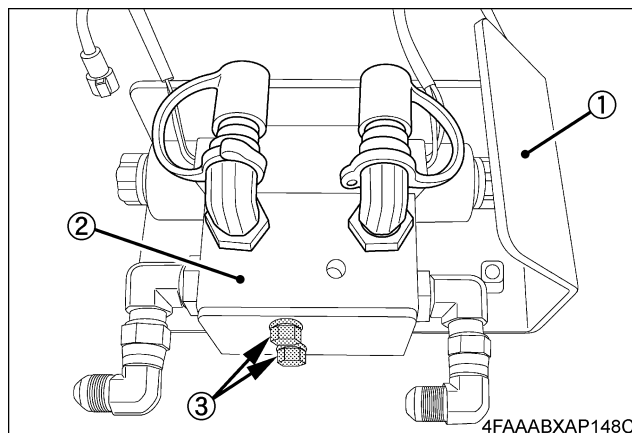

- (1) 3rd function valve cover
(2) 3rd function valve assembly
(3) 2-M10 x 25 bolts with washer

Tightening torque	43.3 to 50.3 N·m (4.41 to 5.13 kgf·m) (31.9 to 37.1 lbf·ft)
-------------------	---

6. Connect the hoses to the 3rd function assembly.

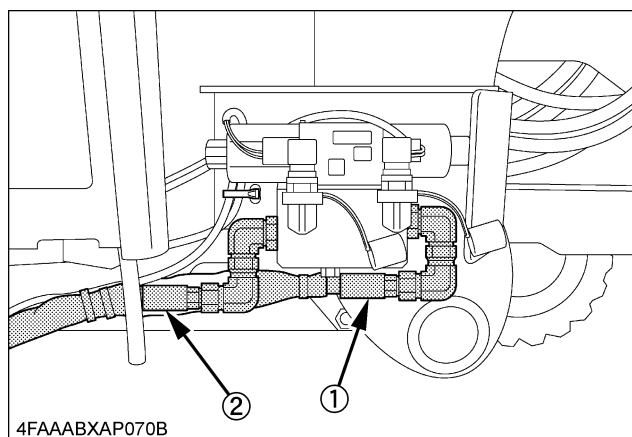

- (1) Inlet hose
(2) Outlet hose

7. Secure the inlet hose and outlet hose with the band as shown below.

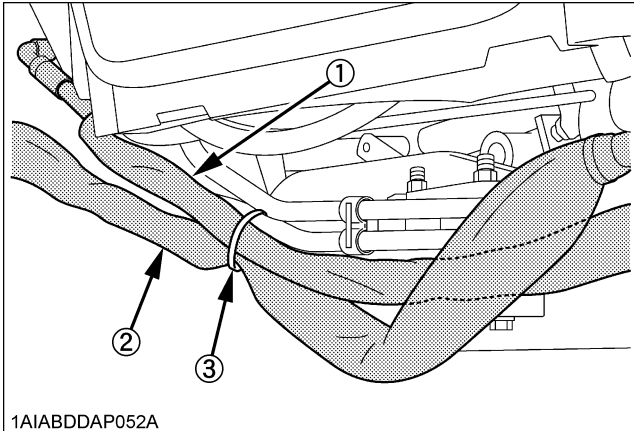

- (1) Inlet hose
(2) Outlet hose
(3) Band

◆ **Adjusting Section of the 3rd function valve fittings (As required)**

1. After installing the loader, adjust the valve fitting angles with loosening the nuts as shown below depending on the loader 3rd function hoses.

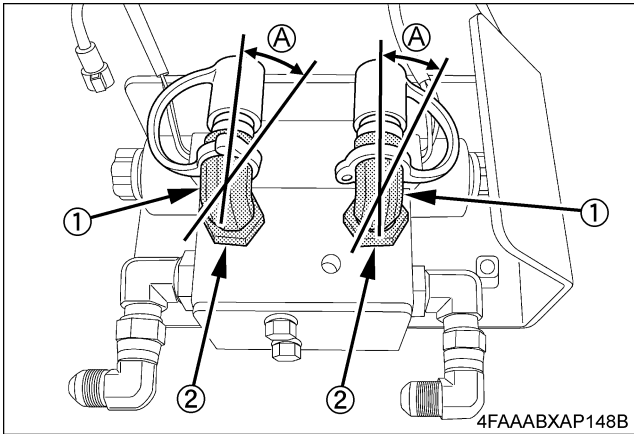

- (1) 2-Fittings
(2) 2-Nuts
(A) 0° to 20°

Tightening torque	88 to 108 N·m (9.0 to 11.0 kgf·m) (57.1 to 79.7 lbf·ft)
-------------------	---

IMPORTANT :

- Before starting this job, be sure to stop the engine and relieve the hydraulic oil pressure completely.
- If you adjust the valve fitting angles, make sure to tighten the nuts securely.
- With the hoses connected, move up and down the loader and make sure the hoses are not extremely tense.

[Equipped with backhoe]

If the backhoe kit has been equipped, disconnect the backhoe inlet pipe first and then remove the female coupler and dust plug.

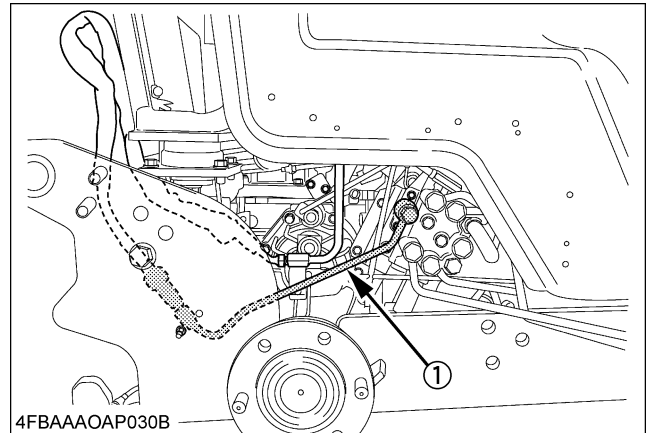

- (1) Backhoe inlet pipe (Disconnect)

NOTE :

- The removed female coupler and dust plug will be used again for the power beyond pipe.

Use the following kit parts as shown below.

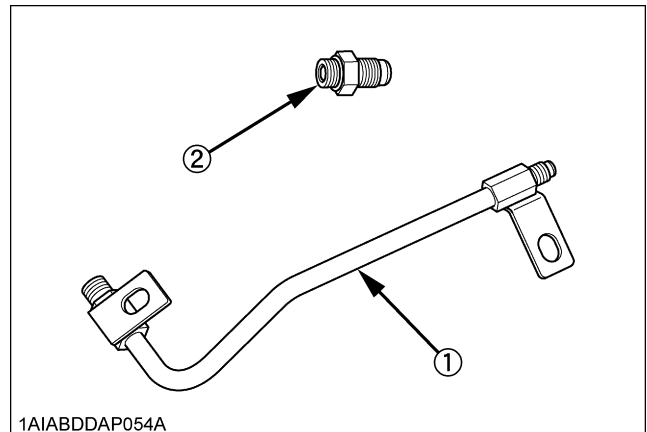

- (1) Power beyond pipe
(2) Adapter

1. Disconnect the front loader power beyond pipe if equipped.

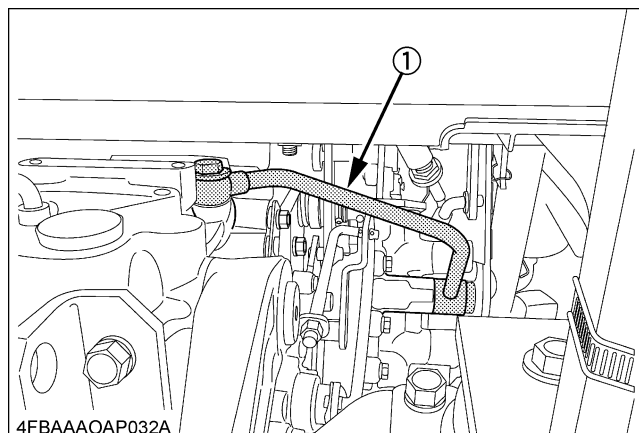

(1) Front loader power beyond pipe

2. Connect the adapter.

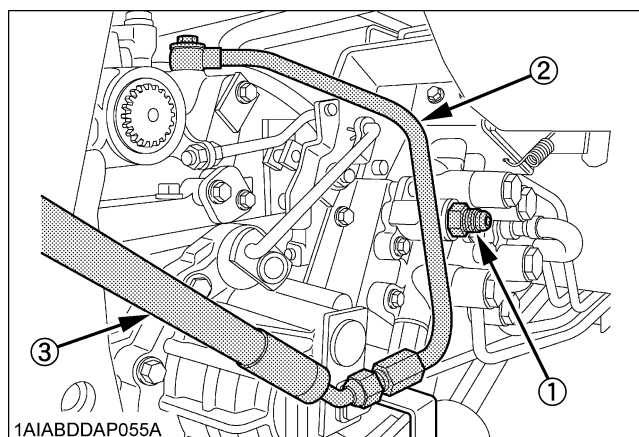

(1) Adapter
(2) Backhoe outlet pipe (in the backhoe kit)
(3) Backhoe outlet hose (in the backhoe kit)

NOTE :

- Refer to the backhoe assembly instructions for the backhoe outlet pipe and backhoe outlet hose.

3. Attach the female coupler and dust plug to the power beyond pipe. At this time, use the female coupler and dust plug in the backhoe kit.

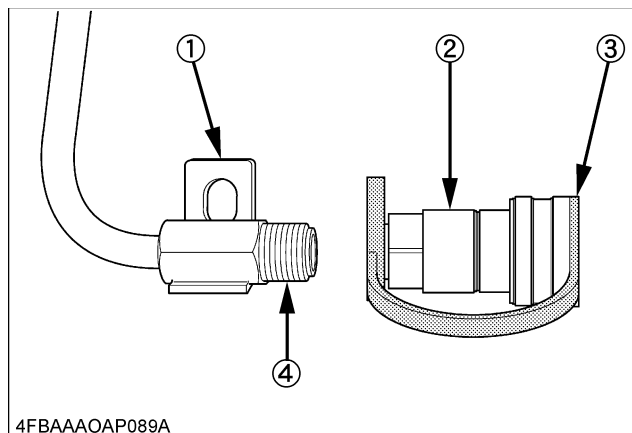

(1) Power beyond pipe
(2) Female coupler (in the backhoe kit)
(3) Dust plug (in the backhoe kit)
(4) Sealing tape

Tightening torque	39 to 60 N·m (3.9 to 6.1 kgf·m) (29 to 44 lbf·ft)
-------------------	---

4. Connect the inlet hose to the adapter and connect the outlet hose to the power beyond pipe respectively.

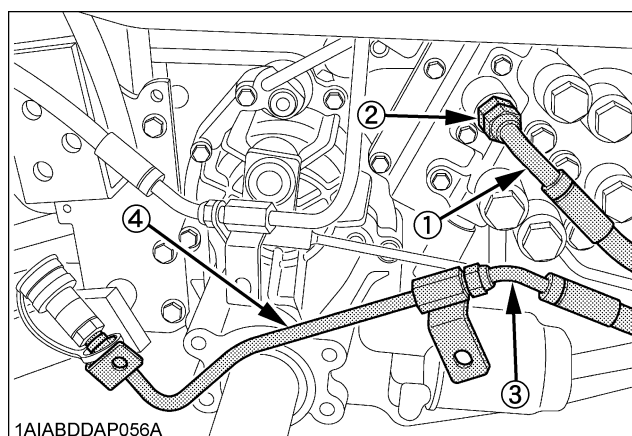

(1) Inlet hose
(2) Adapter
(3) Outlet hose
(4) Power beyond pipe