

# ASSEMBLY INSTRUCTIONS

MODEL LA1153

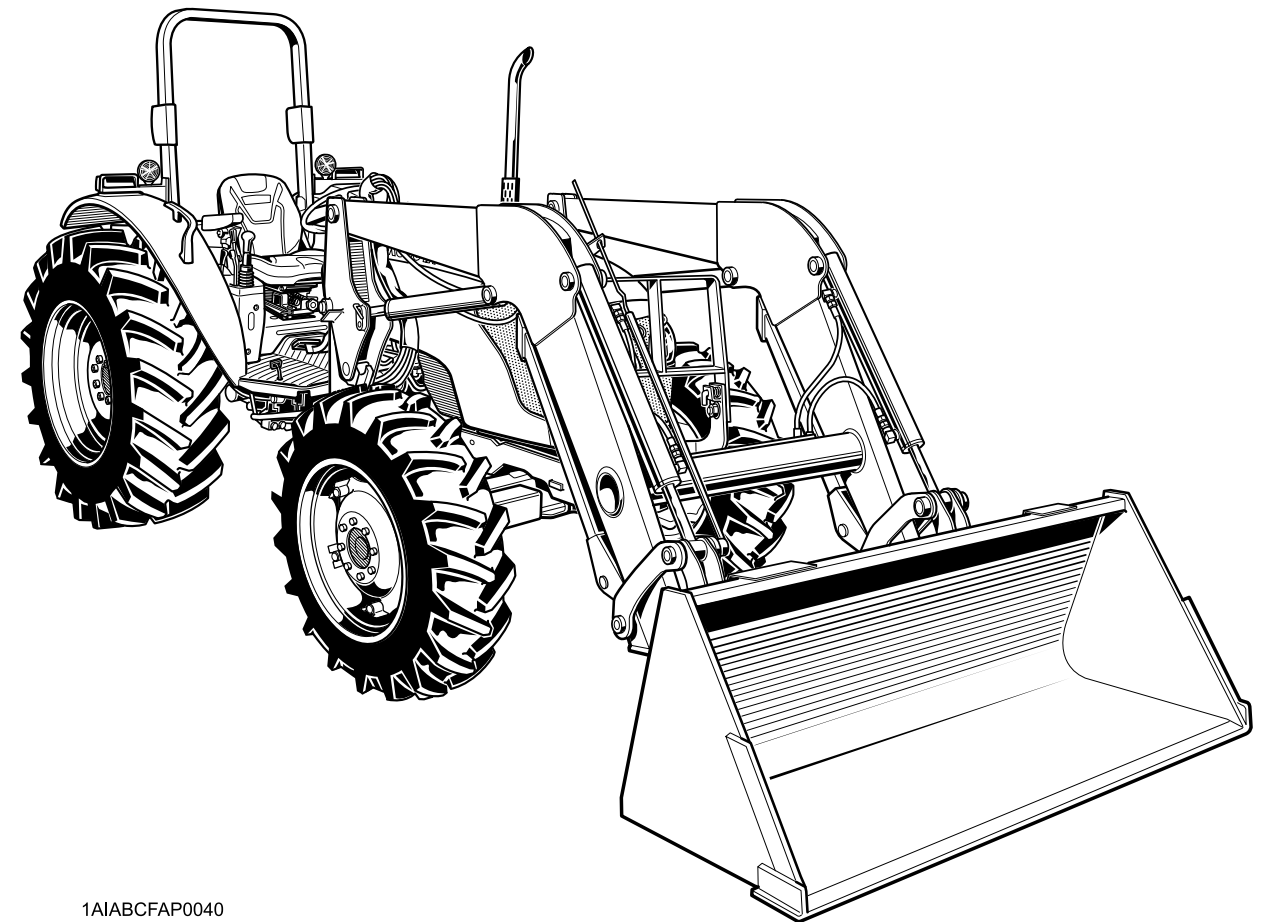

1A1ABCFAP0040

READ AND UNDERSTAND THIS MANUAL  
BEFORE ASSEMBLING

**Kubota**

# CONTENTS



ASSEMBLY INSTRUCTIONS .....	1
TO THE DEALER.....	1
SAFETY .....	1
UNPACKING AND CHECKING PARTS .....	2
Unpacking Wooden Crate.....	2
Checking Parts .....	3
TRACTOR PREPARATION .....	4
Tool Box (CAB MODEL).....	4
ASSEMBLY .....	4
Main Frame.....	4
Tool Box (CAB MODEL) .....	5
Control Valve .....	5
Hydraulic Lines .....	6
Controller and Cables .....	10
Control Valve Cover.....	12
Self-Level Valve (if equipped).....	13
Controller and Cables .....	15
Control Valve Cover.....	18
Accumulator (if equipped).....	18
Multi Coupler (if equipped).....	22
3rd Function (if equipped).....	27
Controller section.....	30
Quick Hitch Frame and Bucket.....	34
Hydraulic Hoses.....	35
PRE-OPERATION CHECK.....	35
Lubrication .....	35
Transmission Fluid.....	35
ESTIMATED ASSEMBLY TIME.....	36
TIGHTENING TORQUE OF BOLTS AND NUTS .....	37
TEMPLATE FOR CONTROLLER CABLE .....	38



# ASSEMBLY INSTRUCTIONS

## TO THE DEALER

1. This manual contains procedures intended to assist the dealer in unpacking and assembling the product before delivering to the customer.  
The customer's purchase is based on confidence in both the product and your store. Observe the procedures in this manual to assemble and adjust equipment for your customer's safety and satisfaction. When fully assembled, check function of each part and feature.
2. The following safety alert symbol marks and indications are found throughout this manual in steps where particular attention is required so as to ensure your safety and to avoid product damage. Observe the instructions in these warnings where indicated.

 <b>DANGER</b>	Indicates an imminently hazardous situation which, if not avoided, will result in death or serious injury.
 <b>WARNING</b>	Indicates a potentially hazardous situation which, if not avoided, could result in death or serious injury.
 <b>CAUTION</b>	Indicates a potentially hazardous situation which, if not avoided, may result in minor or moderate injury.
<b>IMPORTANT :</b>	Indicates that equipment or property damage could result if instructions are not followed.
<b>NOTE :</b>	Gives helpful information

## SAFETY

To prevent accidents, read through the following items before starting work, and always regard safety when working. It is your responsibility to ensure your safety on the job.

### 1. Preparations

- (1) Select a work site which is level, has sufficient space, and is not close to dangerous objects.
- (2) Avoid poorly ventilated rooms.  
Asphyxiation from exhaust fumes is always a possibility that accompanies running an engine.

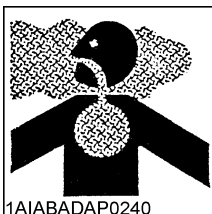

- (3) Working clothes which may be pinched or caught in the equipment must not be worn. Loose clothing can cause serious injury or death.



- (4) Always wear a mask and protective goggles during work when dust or flying debris may be thrown by equipment.

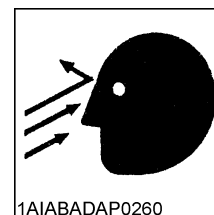

### 2. Assembly and adjustments

- (1) Before assembling equipment, read the assembly instructions for the product to become familiar with the equipment and procedures.
- (2) Use only adequate and required equipment, tools and instruments (e.g. torque wrench, battery hydrometer and etc.).
- (3) Set the parking brake and block wheels to prevent machine (or tractor) movement.
- (4) Lower the attachment or implement to the ground before assembling or adjusting equipment.

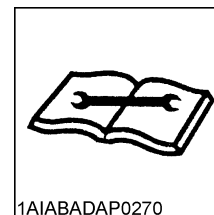

- (5) Before working under suspended or raised equipment, support the equipment or attachment and utilize the valve lock to prevent the machine from falling or moving out of place.

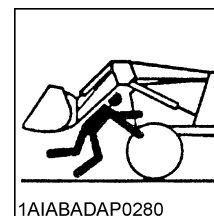

- (6) Keep fire from cigarettes, matches or other ignition sources away from fuel, oil, antifreeze and other flammable materials.



## 3. After assembly check

- (1) Before operating or test driving the equipment, read and understand the operator's manual.
- (2) Once the equipment is fully assembled, select a safe place for a test run. Prevent onlookers from approaching the equipment.

**DANGER**

To avoid personal injury or death:

- Do not start engine or operate levers from anywhere other than the seat.

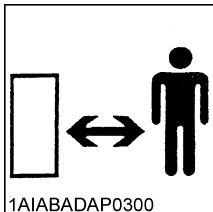
**DANGER**

To avoid personal injury:

- Do not bypass-start the equipment. Short circuiting the starter terminal runs the risk that the equipment will start operating or moving unexpectedly.

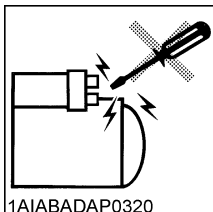
**UNPACKING AND CHECKING PARTS****■ Unpacking Wooden Crate**

1. Cutting metal bands (if two are banded together). Metal bands hold the two crates together as one. Cut these bands and separate the crates.
2. Unpacking the crates
  - (1) Hook a hoist to the 4 corners of the crate and raise the hoist cable until taut. This serves to prevent the upper part of the crate from striking the loader when cut.
  - (2) Saw the crate as indicated in figure 1.

**IMPORTANT :**

- Sawing outside the indicated area may damage the loader or accessory parts.
- Be sure that the crate is free of other obstructions (e.g. nails, staples and etc.).

- (3) Raise the upper part of the crate and remove from the immediate area.
- (4) Remove the remaining slats from the crate. These are indicated by the oblique lines in Figure 1...

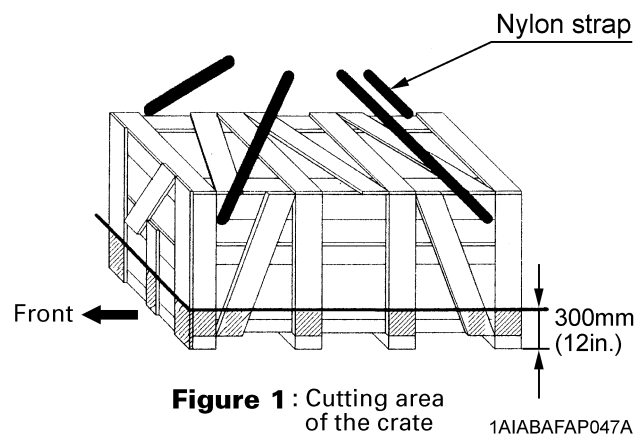

## ■ Checking Parts

Remove all loader components. Referring to the illustration, ensure that all components have been included.

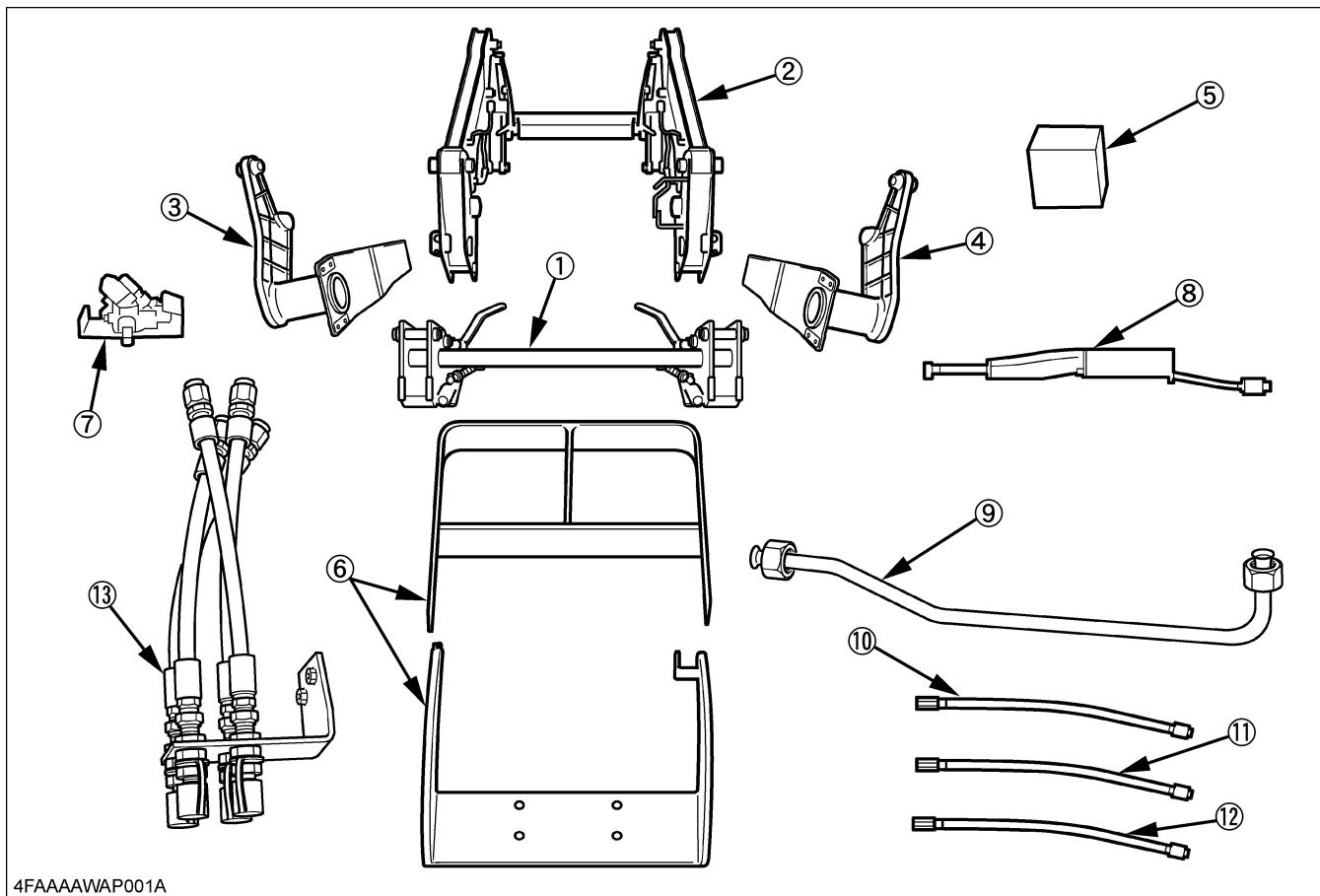

- (1) Quick hitch
- (2) Boom assembly
- (3) Main frame LH
- (4) Main frame RH
- (5) Parts box
- (6) Front guard kit **[M1871]**

- (7 to 12) Valve kit
- [M1822 (ROPS MODEL)]**
- [M1825 (CAB MODEL)]**
- [M1322 (M7040SU)]**
- [M1332 (M7040SUH)]**

- (7) Control valve assembly **[M1822, M1825, M1322, M1332]**
- (8) Control lever stand assembly **[M1822, M1825, M1322, M1332]**
- (9) Return line tube **[M1822, M1825, M1332]**
- (10) Return line hose **[M1322]**
- (11) Hose 6 **[M1822, M1825, M1322, M1332]**
- (12) Hose 5 **[M1822, M1825, M1322, M1332]**
- (13) Connector stay assy **[M1822, M1825, M1322, M1332]**

### NOTE :

- The valve kit and front guard kit are not included with the loader and must be ordered separately.

## TRACTOR PREPARATION

1. Locate the tractor on a firm level surface.  
Lower the implement to the ground, set the parking brake and stop the engine.
2. Set the front tread as follows.

	Front Tread	
	2WD	4WD
M5040 M6040 M7040 M7040SU M7040SUH	1420 mm (55.9 in.)	1520 mm (59.8 in.)

### IMPORTANT :

- Setting the tread wider than recommended may cause premature failure of the front axle components due to excessive stress.
3. For better stability, set the rear tread as follows depending on the requirements of the work being done.

	Rear Tread
M5040 M6040 M7040 M7040SU M7040SUH	1520 mm (59.8 in.) or more

## Tool Box (CAB MODEL)

1. Remove the tool box and stays from the tractor.

## ASSEMBLY

### IMPORTANT :

- Do not tighten any bolts firmly until most components are attached to the tractor.
- Before finally tightening all mounting hardware, start the engine and apply down pressure to the bucket until the loader takes the tractor weight off the front wheels - do not lift the wheels off the ground. Make sure that the mounting pins can be rotated easily.  
Torque all bolts and nuts in this position.
- To avoid damage to hoses, adjust all connections to route hoses away from sharp edges.
- Assemble on a hard surface, preferably concrete.

### Main Frame

1. Install the main frames to the clutch housing and the front axle as shown.

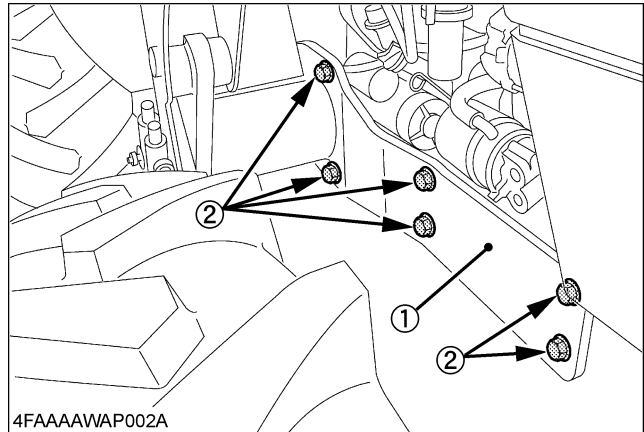

- (1) Main frame  
(2) 16-M20 x 60 bolts  
16-M20 spring lock washers  
16-3/4 hardened plain washers

Tightening torque: 367.8 N-m  
(37.5 kgf-m, 271.2 ft-lbs)

### IMPORTANT :

- While setting up the main frame, keep the air-conditioner and power-steering hoses in their positions.
- If any of them is unavoidably dislocated, return it in its original position with the main frame in place. Otherwise such hose may come in the way of the fan.

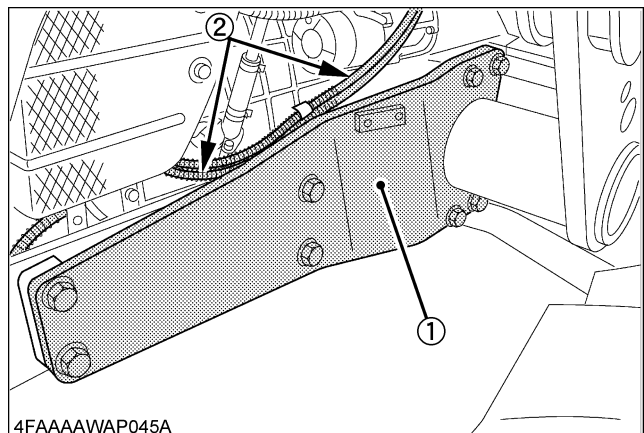

- (1) Main frame  
(2) Hoses

**NOTE :**

- Main frame must be hoisted vertically as shown to avoid contact with the fuel tank.

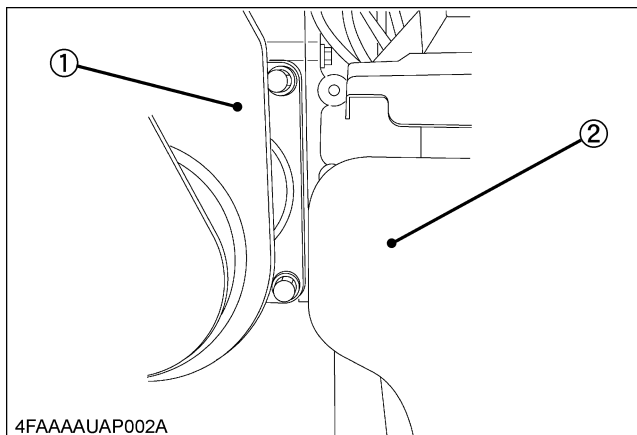

- (1) Main frame  
(2) Fuel tank

**■ Tool Box (CAB MODEL)**

1. Attach the tool box stay to the main frame LH using bolts, nuts and collars.
2. Attach the tool box to the stay using the original fasteners.

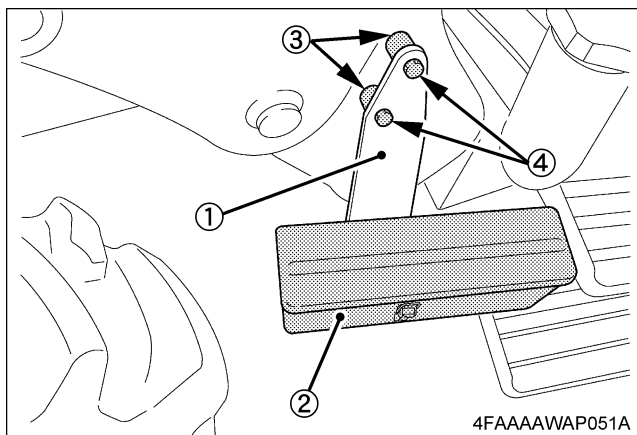

- (1) Tool box stay  
(2) Tool box  
(3) 2-Collars  
(4) 2-M10 x 80 bolts  
2-M10 nuts

**NOTE :**

- When installing the accumulator, be sure to remove the collars then attach the accumulator stay and tool box stay with the original bolts and nuts.

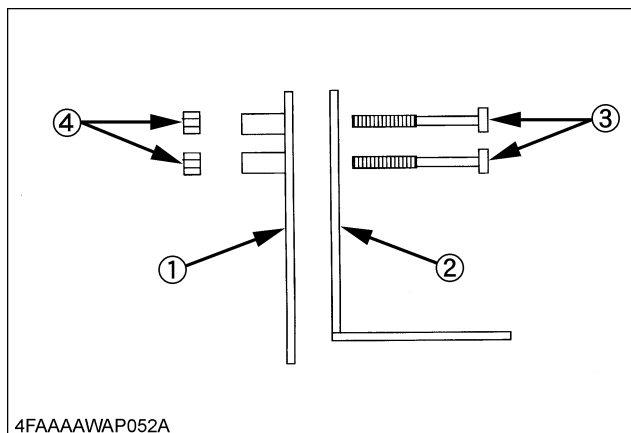

- (1) Accumulator stay  
(2) Tool box stay  
(3) 2-M10 x 80 bolts  
(4) 2-M10 nuts

**■ Control Valve**

1. Attach the valve stay support on the tractor.

**[M1822 (ROPS MODEL)]**

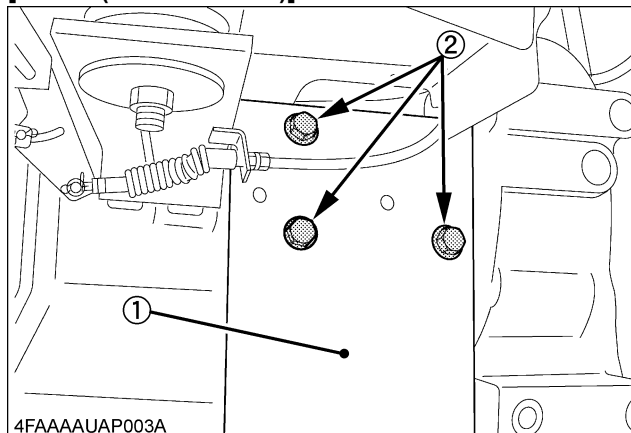

- (1) Valve stay support  
(2) 3-M12 x 75 bolts

**[M1825 (CAB MODEL)]**

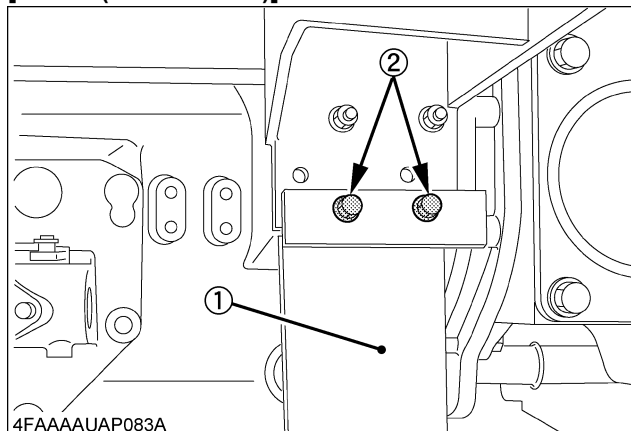

- (1) Valve stay support  
(2) 2-M12 x 40 bolts



2. Fit the valve stay assembly to the valve stay support.

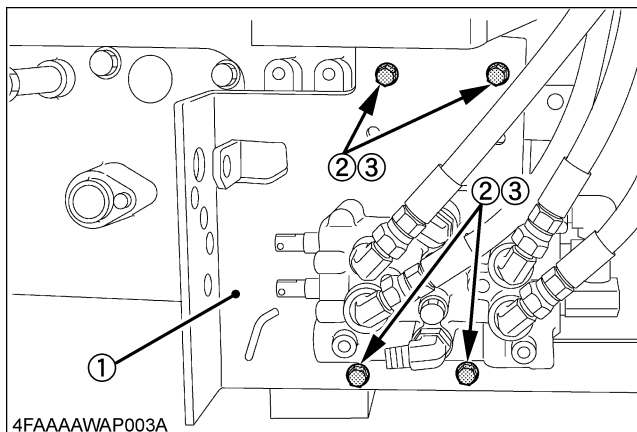

4FAAAWAP003A

(1) Valve stay

(3) 4-M10 spring lock washers

(2) 4-M10 x 110 hex. bolts

## Hydraulic Lines

◆ The tractor's hydraulic power take-off comes in two different types. Check the hydraulic power take-off of the tractor in question and take its specified assembling procedure.

### 1. [Type 1]

Remove the plugs from the tractor's pump port, power beyond port and tank port.

Connect the loader adapters to these ports.

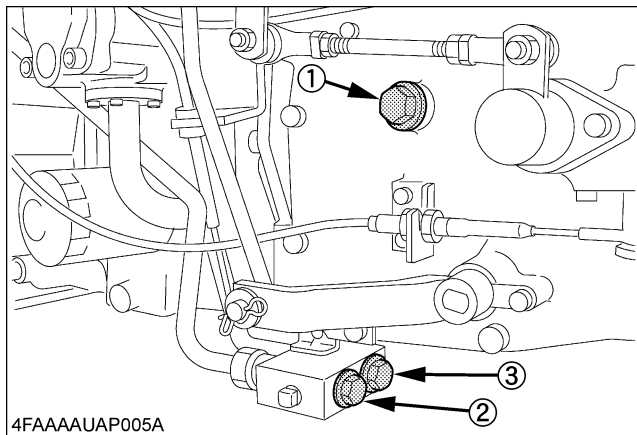

4FAAAUAP005A

(1) Tank port

(2) Power beyond port

(3) Pump port

### NOTE :

- Be sure to hand the above two removed plugs (power beyond port and pump port) to the customer and to ask him/her to store them in a safe place. These two plugs must be back into position when the loader and its component parts have been detached.

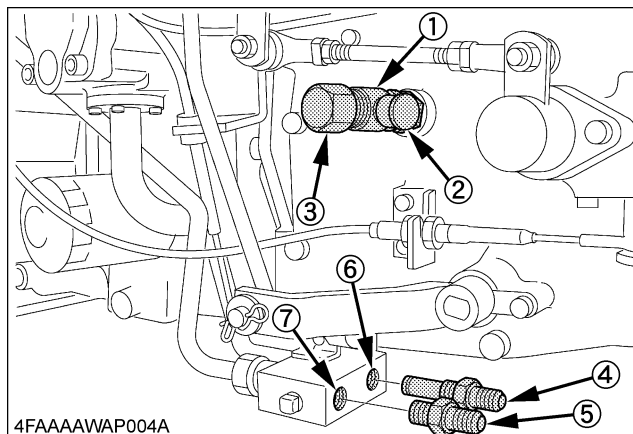

4FAAAWAP004A

(1) Assy adapter 1

(2) Tee, swivel run 7/8

(3) Cap, nut#10, 7/8-14 jic37deg

(4) Adapter assy inlet

(5) Adapter assy power beyond

(6) Pump line port

(7) Power beyond port

### IMPORTANT :

- Holding the hydraulic block, tighten up the adapter. Apply oil on the O-ring and the backup ring.
- Make sure to disconnect the loader adapters (inlet (4) and power beyond (5)) and apply the plugs, removed in step 1 above, to the tractor's pump port and power beyond port when the loader and its component parts have been detached. The pump will be damaged if the engine is started with cap nuts mounted on the adapters (inlet (4) and power beyond (5)).

Tightening torque : 122 N-m

(12.3 kgf-m, 88.5 ft-lbs)

### 2. [Type 2]

Remove the U pipe and tank port plug.

Connect the loader adapters to the tank port.

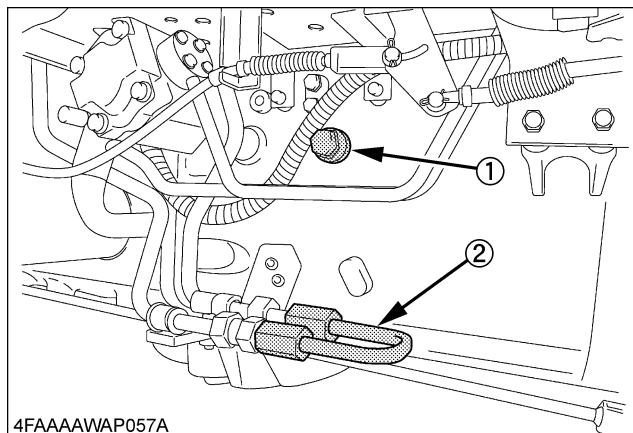

4FAAAWAP057A

(1) Tank port plug

(2) U pipe

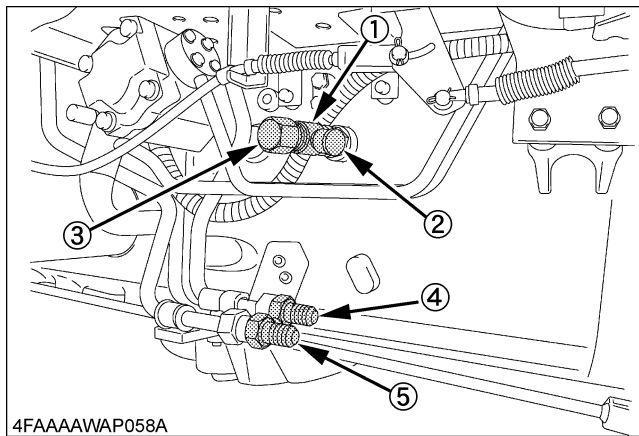

- (1) Assy adapter 1  
 (2) Tee, swivel run 7/8  
 (3) Cap, nut#10, 7/8-14 jic37deg  
 (4) Pump line port  
 (5) Power beyond port

**NOTE :**

- The following adaptor is used for Type 1, not for Type 2.

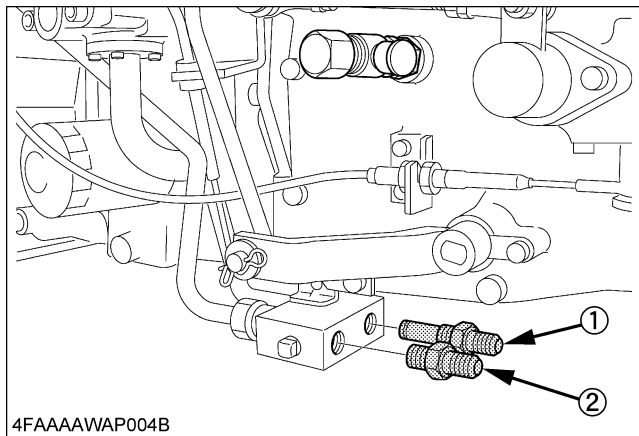

- (1) Adapter assy inlet  
 (2) Adapter assy power beyond

3. Connect the pump line hose as shown.

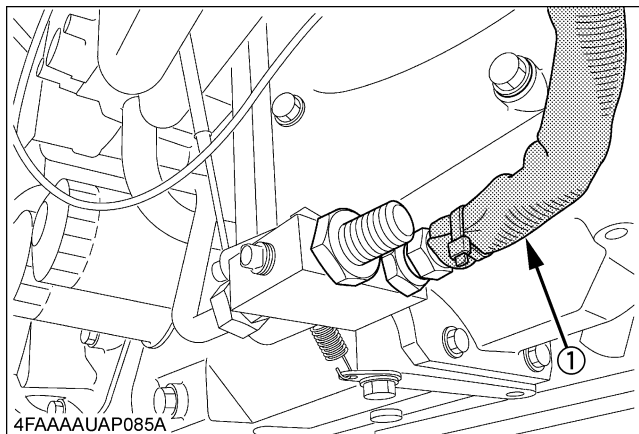

- (1) Pump line hose with sleeve (hose 6, 630 mm (24.8 in.))

4. Connect the pump line hose to the valve.

**IMPORTANT :**

- Indicate that equipment or property damage could result if instructions are not followed.

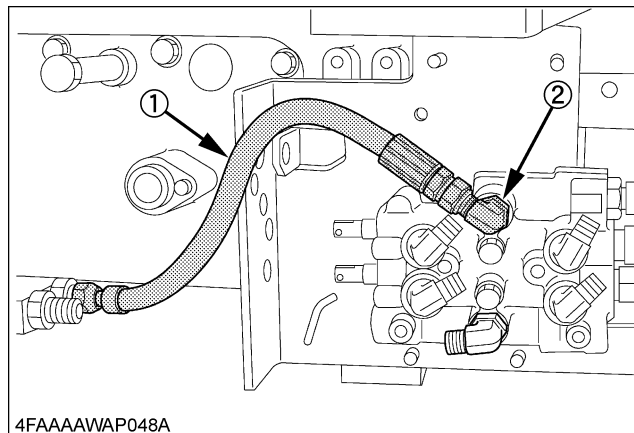

- (1) Pump line hose with sleeve (hose 6, 630 mm (24.8 in.))  
 (2) Valve port marked with an orange dot (Pump line)

5. Connect the power beyond line hose as shown.

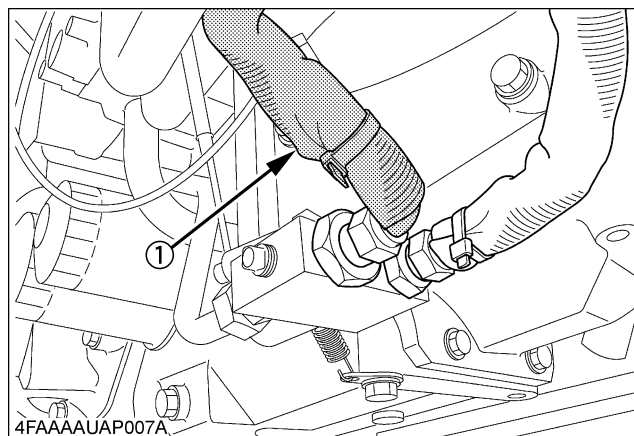

- (1) Power beyond line hose with sleeve  
 [ROPS MODEL] (hose 5, 500 mm (19.7 in.))  
 [CAB MODEL] (hose 5, 450 mm (17.7 in.))

6. Connect the power beyond line hose to the valve.

**IMPORTANT :**

- Indicate that equipment or property damage could result if instructions are not followed.

**[Except M7040SU, M7040SUH]**

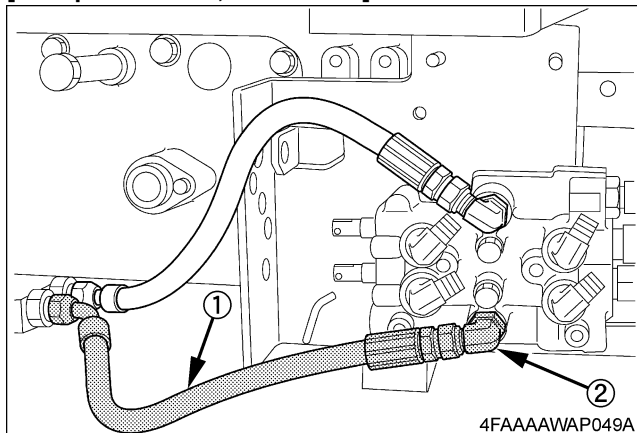

- (1) Power beyond line hose with sleeve  
 [ROPS MODEL] (hose 5, 500 mm (19.7 in.))  
 [CAB MODEL] (hose 5, 450 mm (17.7 in.))  
 (2) Valve port marked with a green dot (Power beyond line)

**[M7040SU, M7040SUH]**

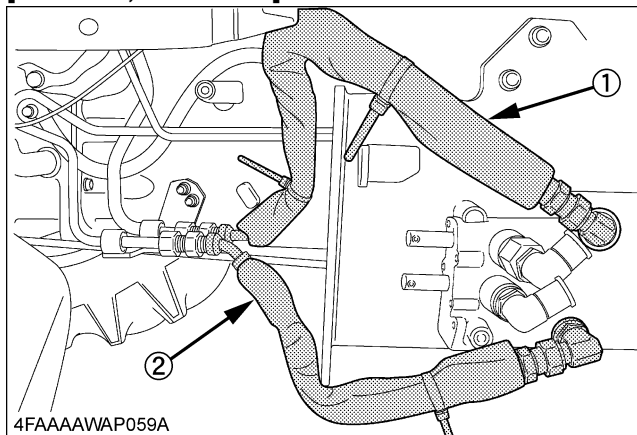

- (1) Pump line hose with sleeve  
 (2) Power beyond line hose with sleeve

**IMPORTANT :**

- If the loader operates slowly up and down while operating the tractor, turn off the tractor immediately. Check connecting pump line hose and power beyond line hose to verify that it is installed correctly to the control valve.
- To verify the hoses, the power beyond line hose should be installed to the green colored port and the pump line should be installed to the orange colored port of the valve.
- If the pump line hose and power beyond line hose are installed incorrectly, the tractor hydraulic pump may experience malfunction.

7. **[M5040, M6040, M7040, M7040SUH]**

Connect the return line tube.

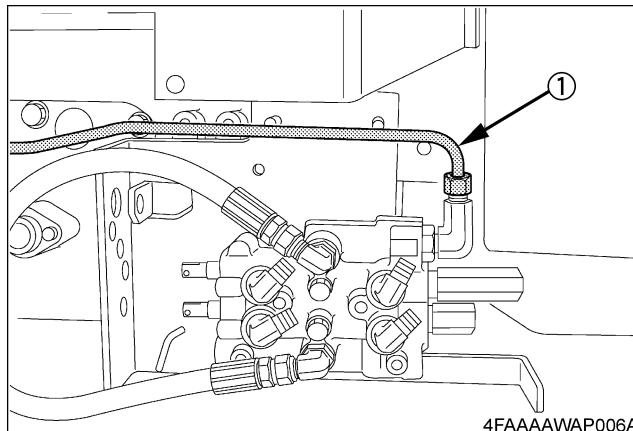

- (1) Return line tube

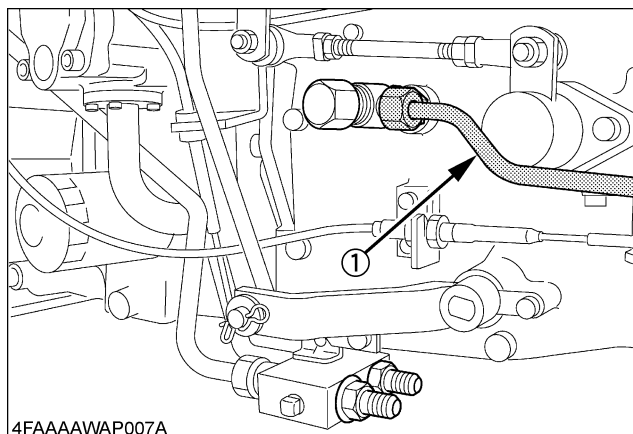

- (1) Return line tube

# 8. [M7040SU]

Connect the return line hose.

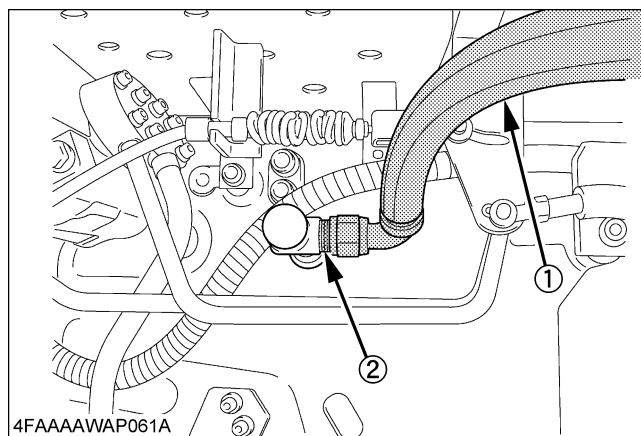
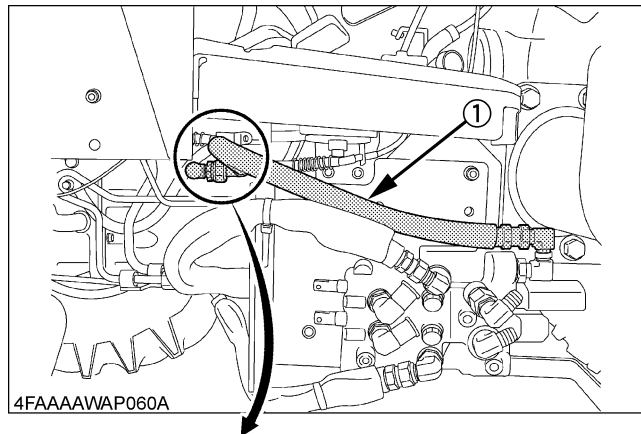

- (1) Return line hose
- (2) Tee, swivel run 7/8

9. Fit the connector assembly stay to the main frame.

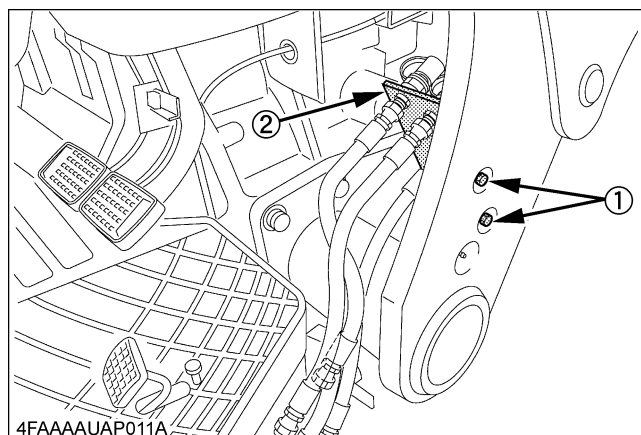

- (1) 2-M10 x 45 bolts
- (2) Connector assy stay

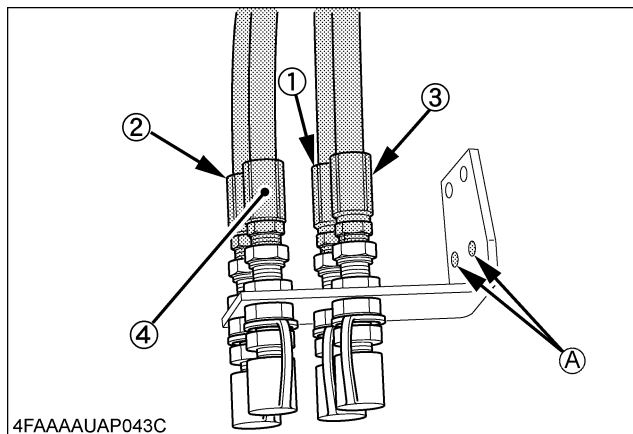

- (1) Hydraulic hose (Red)
- (2) Hydraulic hose (Blue)
- (3) Hydraulic hose (Yellow)
- (4) Hydraulic hose (White)
- (A) Use the holes.

10. Connect the hoses between the connector assembly stay and the valve.

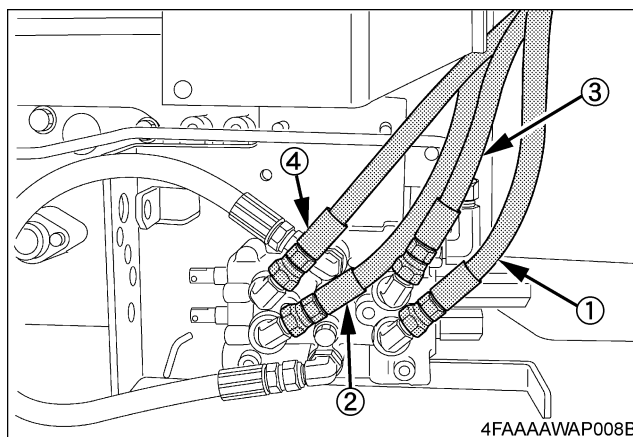

- (1) Hydraulic hose (Red 500 mm (19.7 in.))
- (2) Hydraulic hose  
[ROPS MODEL] (Blue 500 mm (19.7 in.))  
[CAB MODEL] (Blue 510 mm (20.1 in.))
- (3) Hydraulic hose (Yellow 560 mm (22.0 in.))
- (4) Hydraulic hose  
[ROPS MODEL] (White 455 mm (17.9 in.))  
[CAB MODEL] (White 435 mm (17.1 in.))

## Controller and Cables

### Except M7040SUH

1. Remove the cover cap of the tractor.

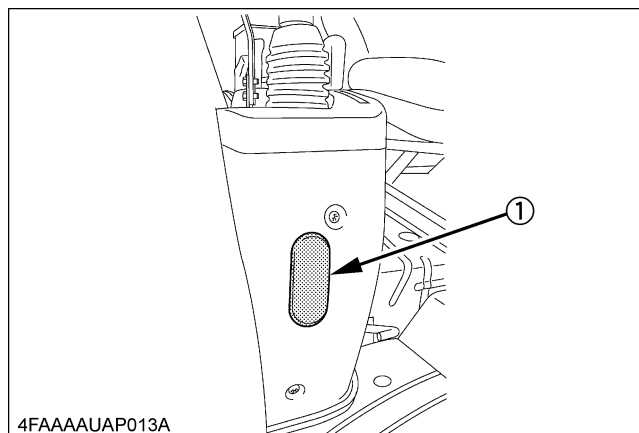

(1) Cover cap

2. Fit the controller stay 2 in position.

### [M1822 (ROPS MODEL)]

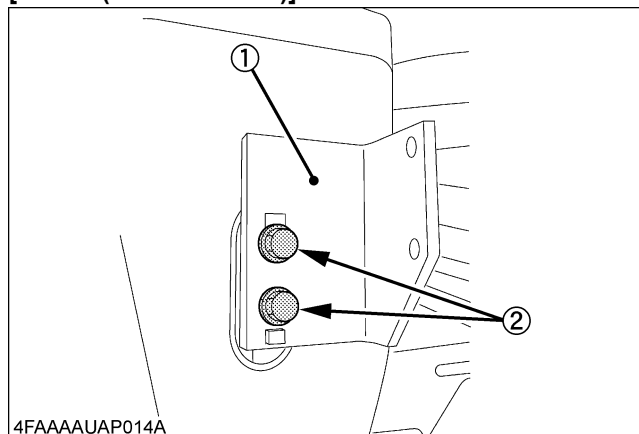

(1) Controller stay 2

(2) 2-M10 x 40 bolts

### [M1825 (CAB MODEL)]

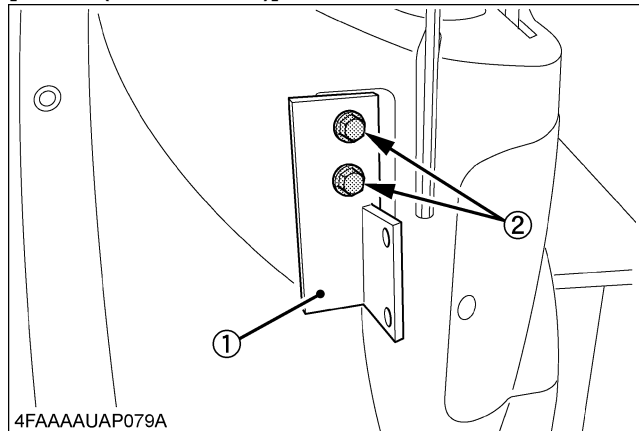

(1) Controller stay 2

(2) 2-M10 x 70 bolts  
2-M10 Spring lock washer

3. Fix the controller assembly stay 1 to the controller stay 2.

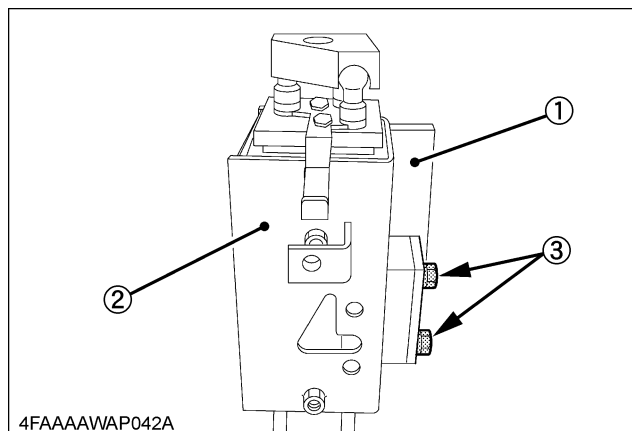

(1) Controller stay 2

(3) 2-M8 x 18 bolts

(2) Controller assy stay 1

4. Pass the wire cable in the specified route.

### [M1822 (ROPS MODEL)]

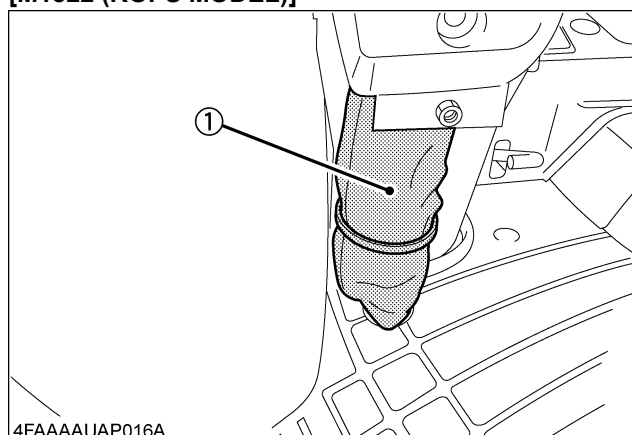

(1) 3-Assy cable with sleeve

### [M1825 (CAB MODEL)]

- (1) Remove the mat.
- (2) Pass the cable through the opening.
- (3) Make a cut in the mat so that the cable can pass through the slit.

### NOTE :

- For the cutting position, refer to the pattern sheet on last page.
- Keep the wire cable hidden with the sleeve. Pass the sleeve down through the bottom of the hole.

5. Install the control lever.

**[M1822 (ROPS MODEL)]**

Install the lever pointing straight to the traveling direction.

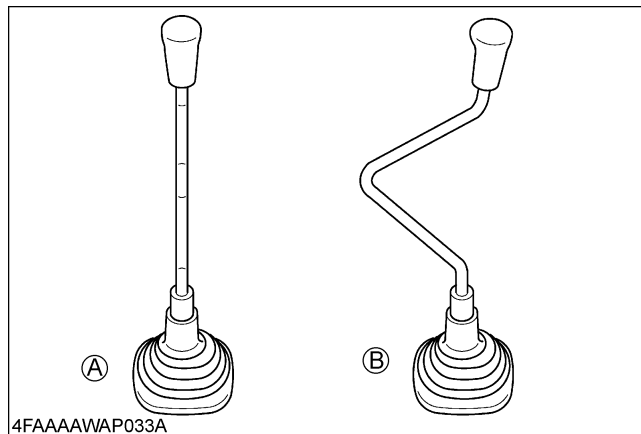

(A) "FRONT"  
(B) "SIDE"

**[M1825 (CAB MODEL)]**

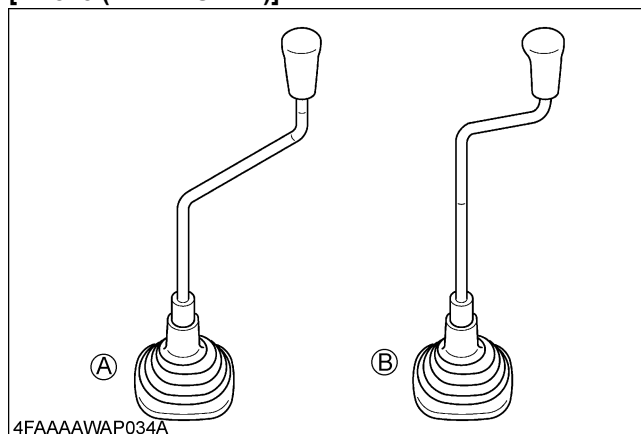

(A) "FRONT"  
(B) "SIDE"

◆ **M7040SUH**

**[M1332]**

1. Fit the controller stay in position.
2. Fix the controller assy to the controller stay and follow the step 6 below.

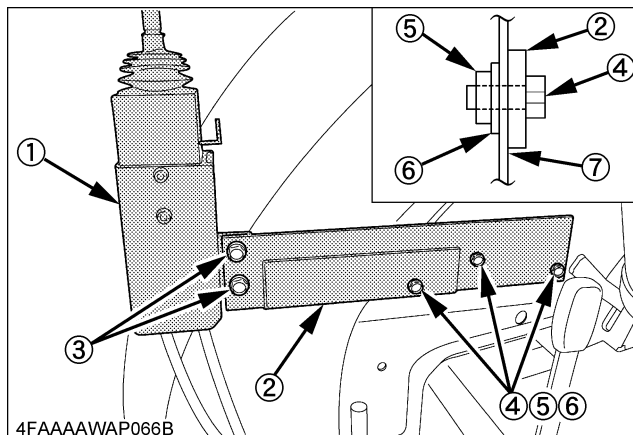

- (1) Controller assy
- (2) Controller stay
- (3) 2-M10 x 30 bolts
- (4) 3-M8 x 30 bolts

- (5) 3-M8 nuts
- (6) 3-Spring washers
- (7) Fender

◆ **All models**

6. Set the lock lever on the cable controller to the neutral position.

**IMPORTANT :**

- Control lever should be neutral and be locked with lock lever.

**[Except M7040SUH]**

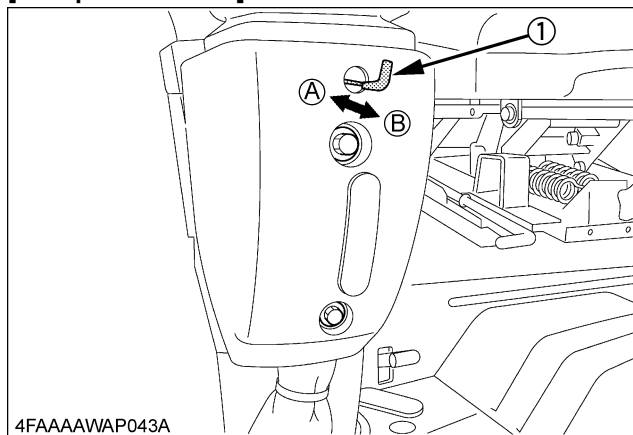

- (1) Lock lever

- (A) "LOCK"
- (B) "UNLOCK"

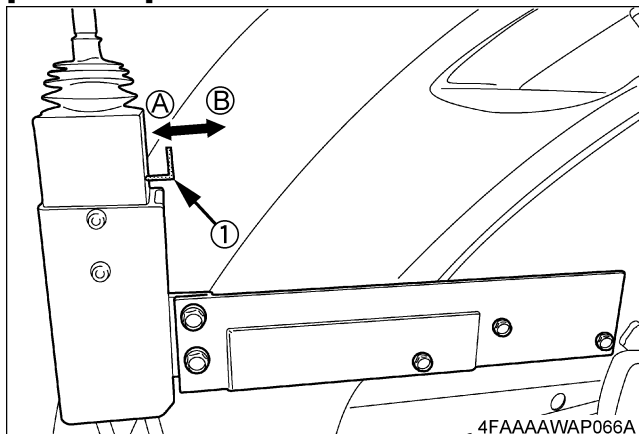
**[M7040SUH]**

(1) Lock lever

(A) "LOCK"

(B) "UNLOCK"

7. Install one lock nut to each cable end. Then route the cable ends through the valve stay.

**NOTE :**

- The cable with blue tape is for boom section and the cable with red tape is for bucket section.
8. Install the other lock nuts to the cable ends and adjust the location of lock nuts so that the cable end hole aligns with the spool hole. Then tighten the lock nuts.
9. Loosen the M6 lock nuts of the cable ends. Turn the cable ends and spools so that the direction of the pins is horizontal. Then retighten the M6 lock nuts.

10. Connect the cable to the spools with pins.

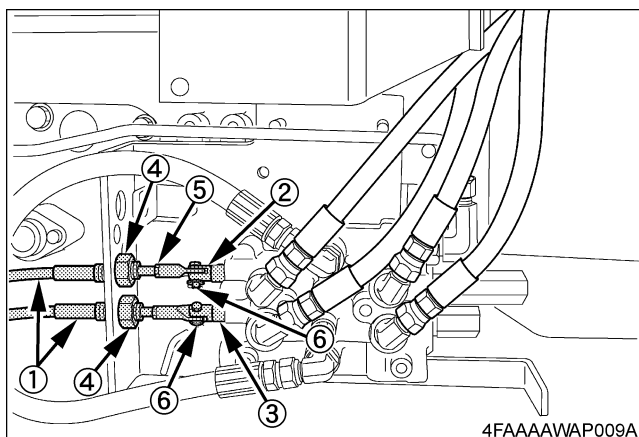

(1) Controller cable

(2) Boom section

(3) Bucket section

(4) Lock nuts

(5) M6 lock nuts

(6) 2-Pins

2-Snap pins

2-Plain washers

11. Attach the lever cover in place.

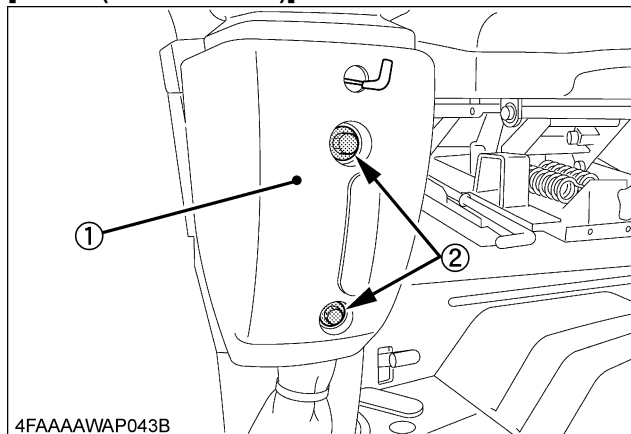
**[M1822 (ROPS MODEL)]**

(1) Lever cover

(2) 2-M8 flange bolts

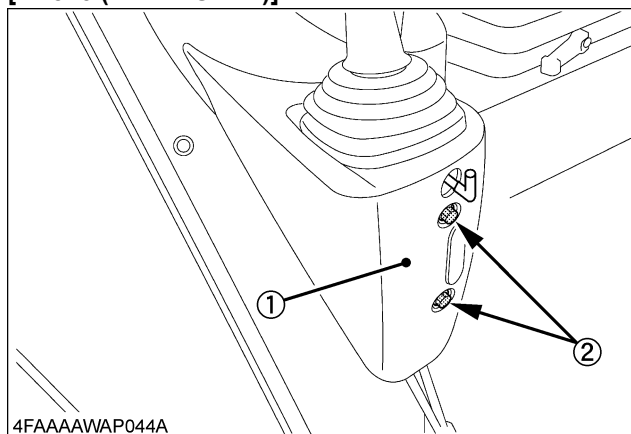
**[M1825 (CAB MODEL)]**

(1) Lever cover

(2) 2-M8 flange bolts

**Control Valve Cover**

1. Attach the valve cover to the valve stay.

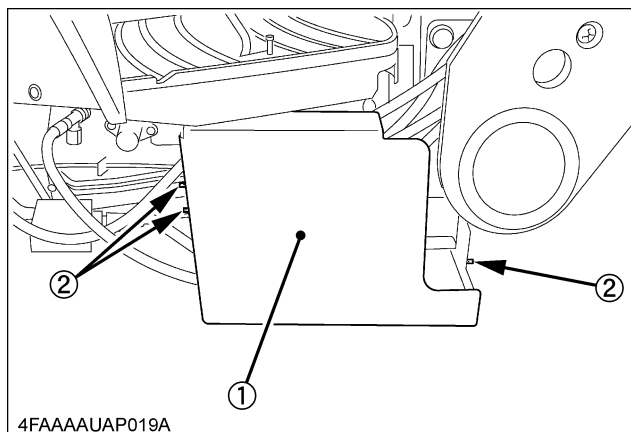

(1) Valve cover

(2) 3-M8 bolts

# [M1332]

2. Apply the label included in valve kit.

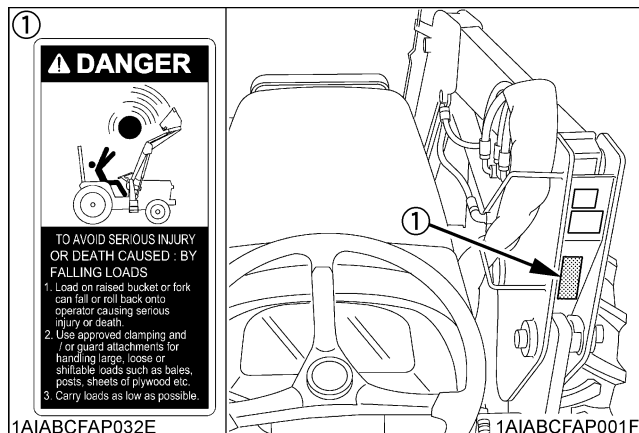

(1) Label (Part No. 7J417-5643-1)

## Self-Level Valve (if equipped)

1. Put the stud bolt in the valve stay support.

### [M1858 (ROPS MODEL)]

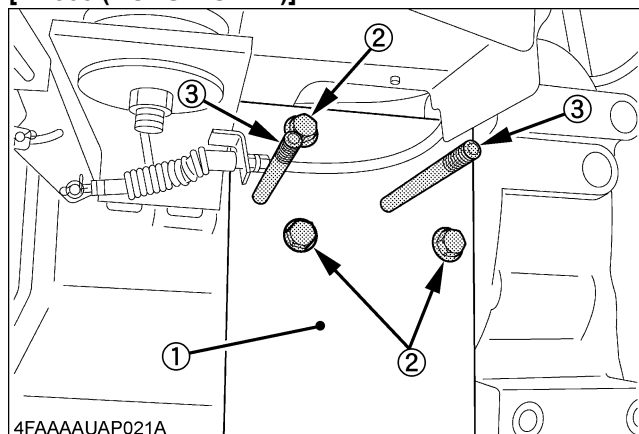

(1) Valve stay support

(2) 3-M12 x 75 bolts

(3) 2-Stud bolts

### [M1859 (CAB MODEL)]

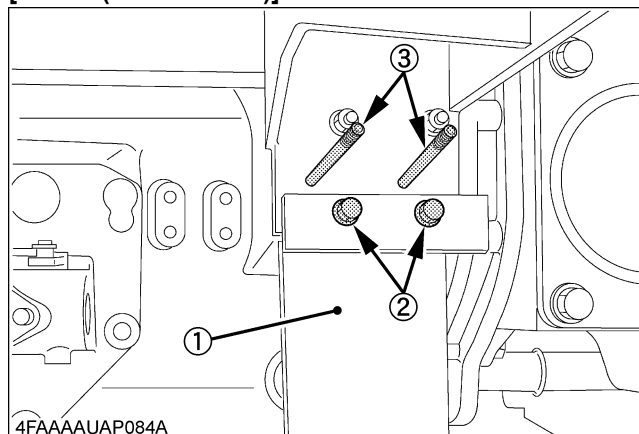

(1) Valve stay support

(2) 2-M12 x 40 bolts

(3) 2-Stud bolts

2. Temporarily assemble the valve stay to the valve stay support.

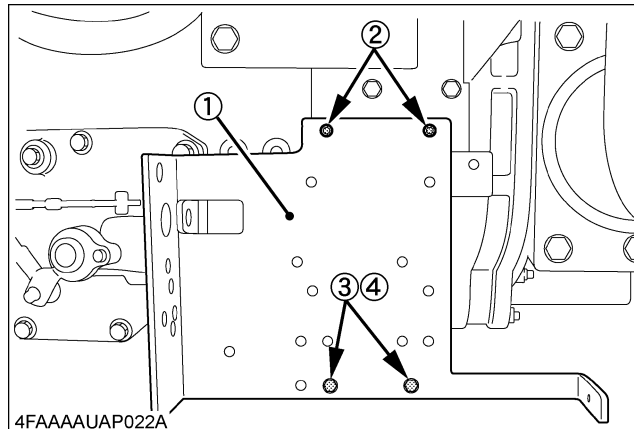

(1) Valve stay

(2) 2-Stud bolts

(3) 2-M10 x 110 hex. bolts

(4) 2-M10 spring lock washers

3. Attach the self-level valve assy to the valve stay.

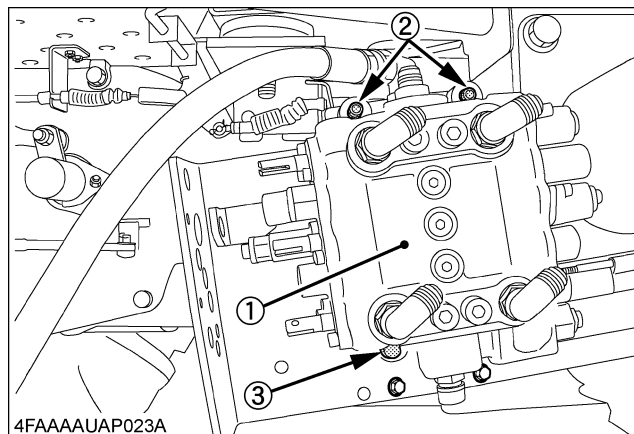

(1) Self-level valve assy

(2) 2-M10 nuts

2-M10 spring lock washers

(3) M10 x 60 hex. bolt



4. Connect the pump line hose and tank hose.

**IMPORTANT :**

- Indicate that equipment or property damage could result if instructions are not followed.

[View from the top of the valve]

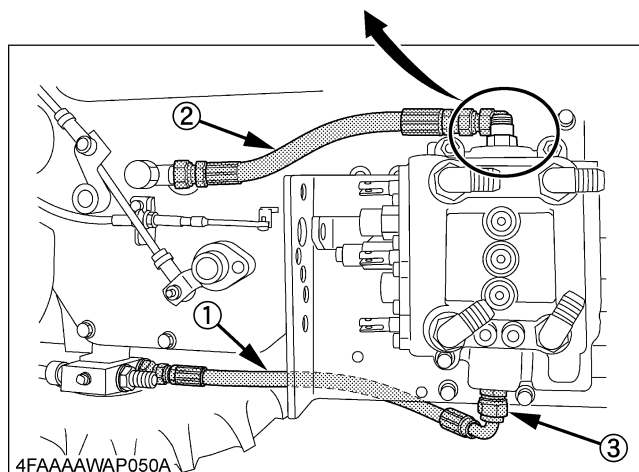
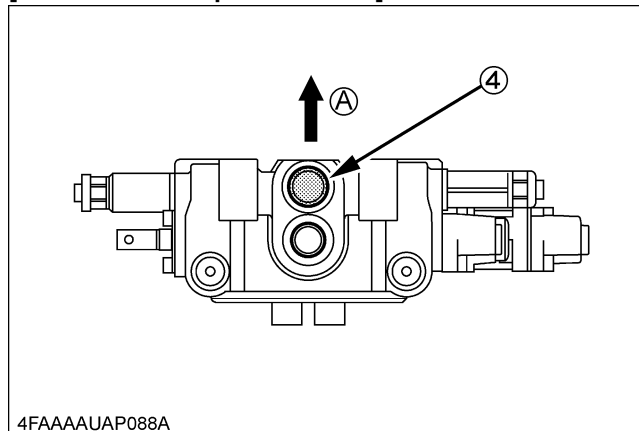

- (1) Pump line hose with sleeve (hose 6)  
[ROPS MODEL] (580 mm (22.8 in.))  
[CAB MODEL] (500 mm (19.7 in.))
- (2) Hydraulic tank hose with sleeve  
[ROPS MODEL] (345 mm (13.6 in.))  
[CAB MODEL] (320 mm (12.6 in.))
- (3) Valve port marked with an orange dot (Pump line)
- (4) Valve port (Tank)
- (A) Tractor side

5. Connect the power beyond hose.

**IMPORTANT :**

- Indicate that equipment or property damage could result if instructions are not followed.

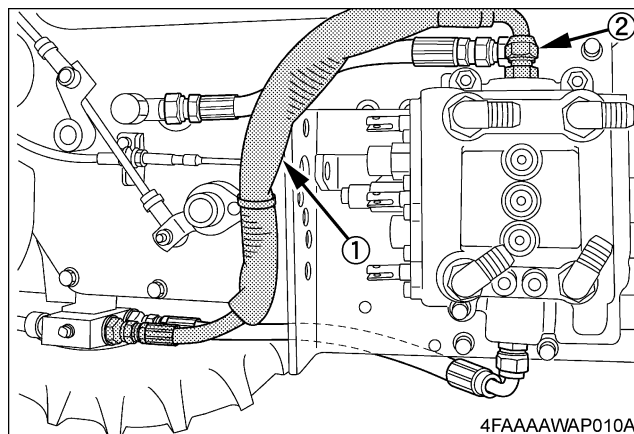

- (1) Power beyond line hose with sleeve (hose 5)  
[ROPS MODEL] (730 mm (28.4 in.))  
[CAB MODEL] (670 mm (26.4 in.))
- (2) Valve port marked with a green dot (Power beyond line)

**IMPORTANT :**

- If the loader operates slowly up and down while operating the tractor, turn off the tractor immediately. Check connecting pump line hose and power beyond line hose to verify that it is installed correctly to the control valve.
- To verify the hoses, the power beyond line hose should be installed to the green colored port and also the pump line should be installed to the orange colored port of the valve.
- If the pump line hose and power beyond line hose are installed incorrectly, the tractor hydraulic pump may experience malfunction.

6. Connect the hose between the valve and the coupler.

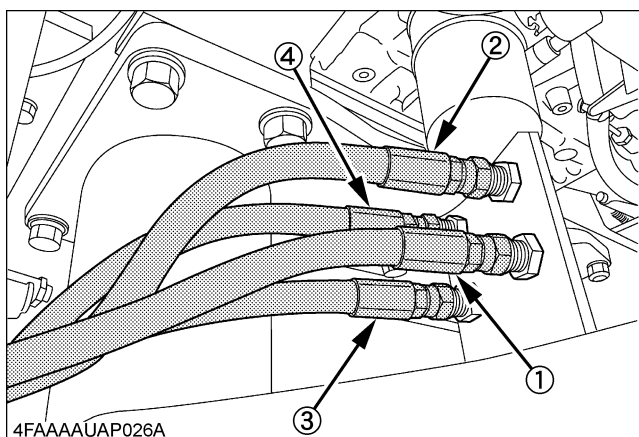
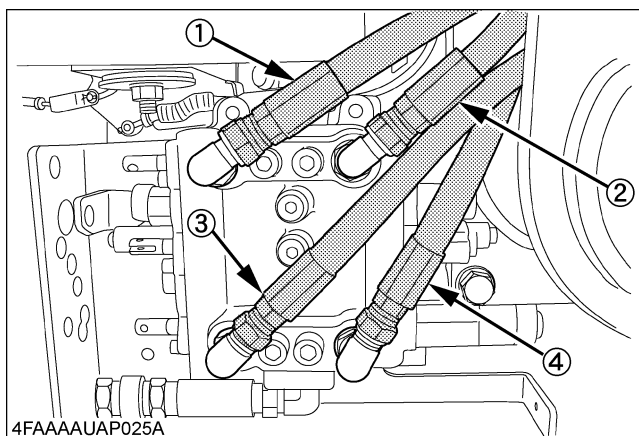

- (1) Hydraulic hose  
[ROPS MODEL] (Red 420 mm (16.5 in.))  
[CAB MODEL] (Red 465 mm (18.3 in.))
- (2) Hydraulic hose (Blue 400 mm (15.7 in.))
- (3) Hydraulic hose  
[ROPS MODEL] (Yellow 500 mm (19.7 in.))  
[CAB MODEL] (Yellow 520 mm (20.5 in.))
- (4) Hydraulic hose  
[ROPS MODEL] (White 455 mm (17.9 in.))  
[CAB MODEL] (White 485 mm (19.1 in.))

## ■ Controller and Cables

1. Remove the cover cap of the tractor.

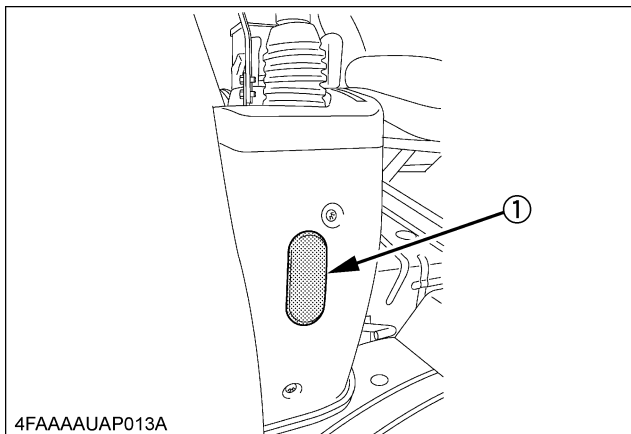

(1) Cover cap

2. Fit the controller stay 2 in position.

**[M1858 (ROPS MODEL)]**

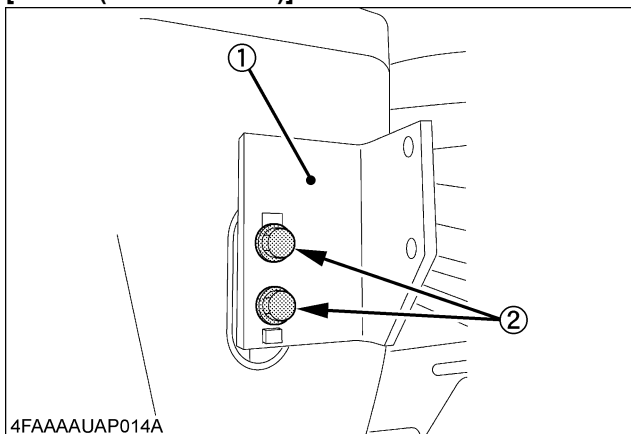

(1) Controller stay 2

(2) 2-M10 x 40 bolts

**[M1859 (CAB MODEL)]**

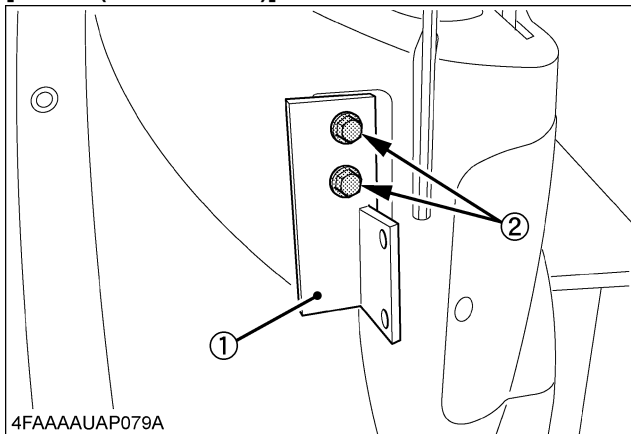

(1) Controller stay 2

(2) 2-M10 x 70 bolts  
2-M10 spring lock washer

3. Fix the controller assembly stay 1 to the controller stay 2.

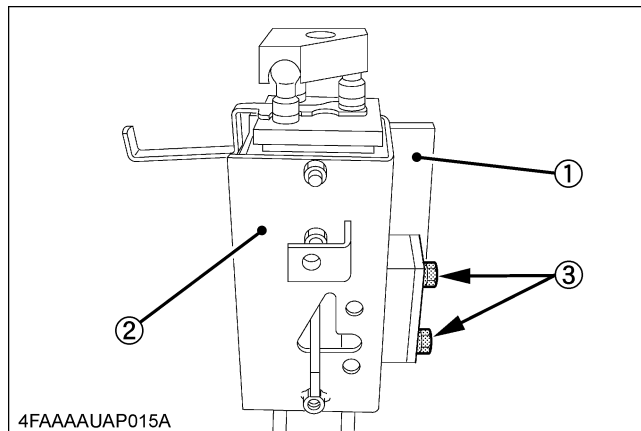

- (1) Controller stay 2  
(2) Controller assy stay 1  
(3) 2-M8 x 18 bolts

4. Pass the wire cable in the specified route.

**[M1858 (ROPS MODEL)]**

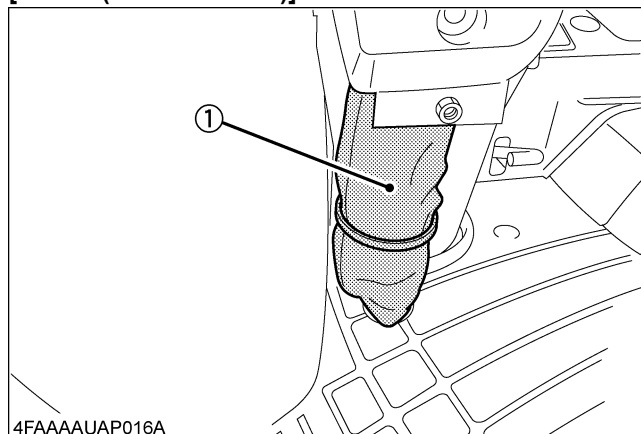

- (1) 3-Assy cable with sleeve

**NOTE :**

- Keep the wire cable hidden with the sleeve. Pass the sleeve down through the bottom of the hole.

5. Install the control lever.

**[M1858 (ROPS MODEL)]**

Install the lever pointing straight to the traveling direction.

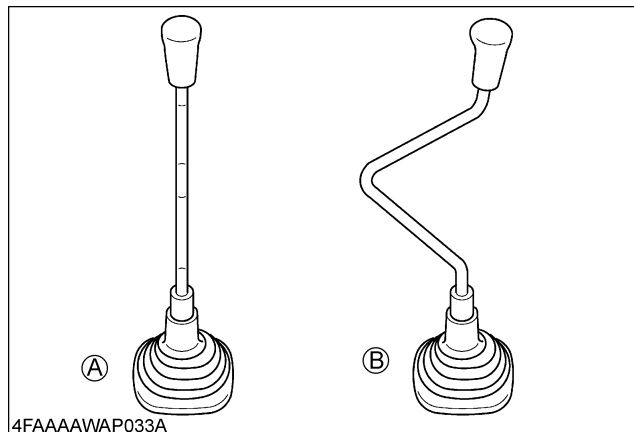

- (A) "FRONT"  
(B) "SIDE"

**[M1859 (CAB MODEL)]**

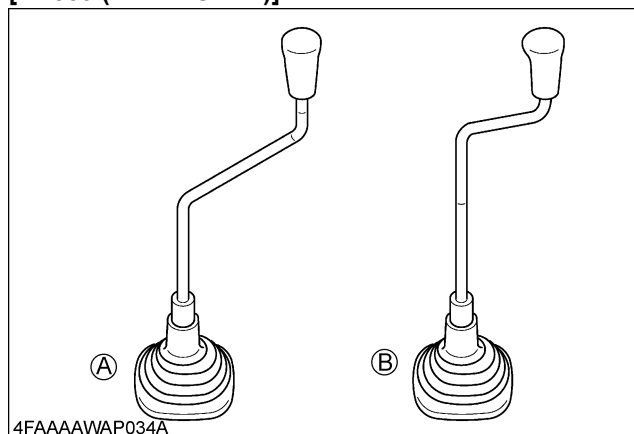

- (A) "FRONT"  
(B) "SIDE"

6. Set the lock lever on the cable controller to the neutral position.

**IMPORTANT :**

- Control lever should be neutral and be locked with lock lever.

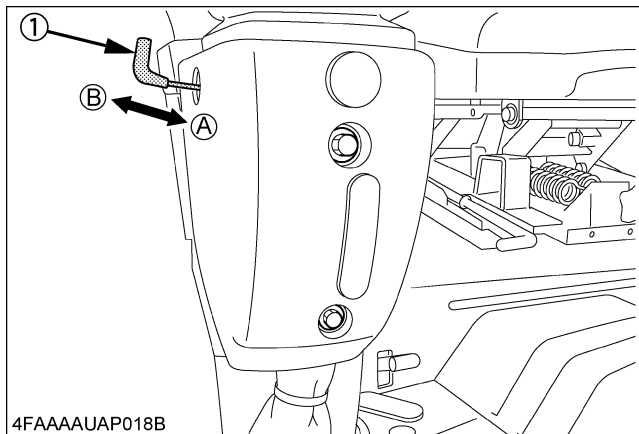

(1) Lock lever

(A) "LOCK"  
(B) "UNLOCK"

7. Install one lock nut to each cable end. Then route the cable ends through the valve stay.

**NOTE :**

- The cable with blue tape is for boom section and the cable with red tape is for bucket section and the cable with gray tape is for switch section.
- Connect the switch section, keeping the self-level on/off lever downward.

**IMPORTANT :**

- Check the spool position at first. It must be same length like other spools.

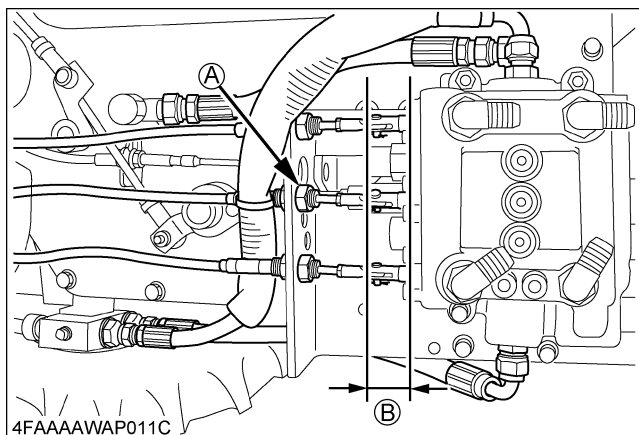

(A) For switch section

(B) Same length (30 mm (1.2 in.))

8. Install the other lock nuts to the cable ends and adjust the location of lock nuts so that the cable end hole aligns with the spool hole. Then tighten the lock nuts.
9. Loosen the M6 lock nuts of the cable ends. Turn the cable ends and spools so that the direction of the pins is horizontal. Then retighten the M6 lock nuts.

10. Connect the cable to the spools with pins.

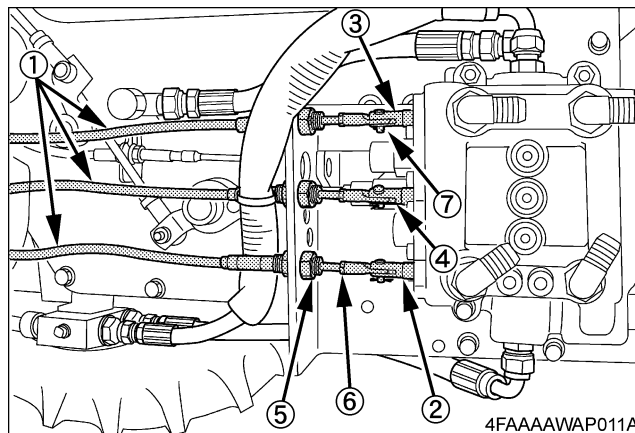

(1) Controller cable  
(2) Boom section  
(3) Bucket section  
(4) Switch section

(5) 6-Lock nuts  
(6) 3-M6 lock nuts  
(7) 3-Pins  
3-Snap pins

11. Attach the lever cover in place.

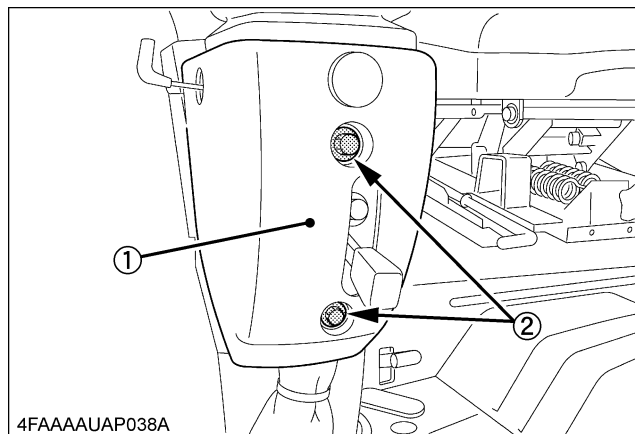

(1) Lever cover

(2) 2-M8 flange bolts

**NOTE :**

- The self-level adjustment procedure is referred to in the operator's manual.

## ■ Control Valve Cover

1. Attach the valve cover to the valve stay.

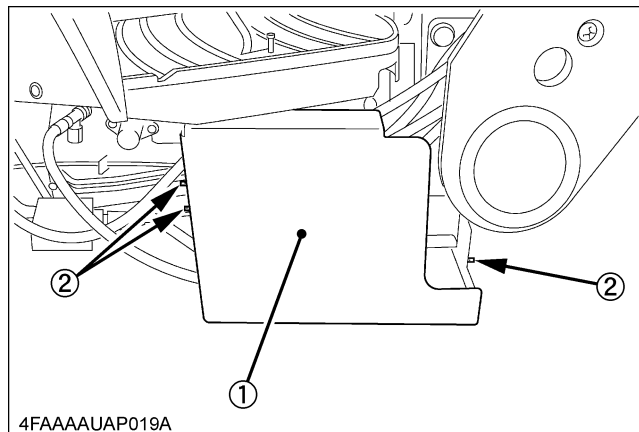

(1) Valve cover

(2) 3-M8 bolts

## ■ Accumulator (if equipped)

[M1866]

### IMPORTANT :

When the control valve is of self-level type:

- If the machine is equipped with the optional self-level valve, fit the accompanying orifice to the accumulator assembly (RH) in the following procedure.
- If the machine does not have a self leveling valve, the orifice is not needed.
- Wind 10 mm (0.39 in.) thick rubber around the accumulator.
- Kit comes with two 10 mm (0.39 in.) thick strips and two 6.35 mm (0.25 in.) strips. Discard the 6.35 mm (0.25 in.) strips and use the 10 mm (0.39 in.) strips.

1. Remove the adapter from the accumulator valve.

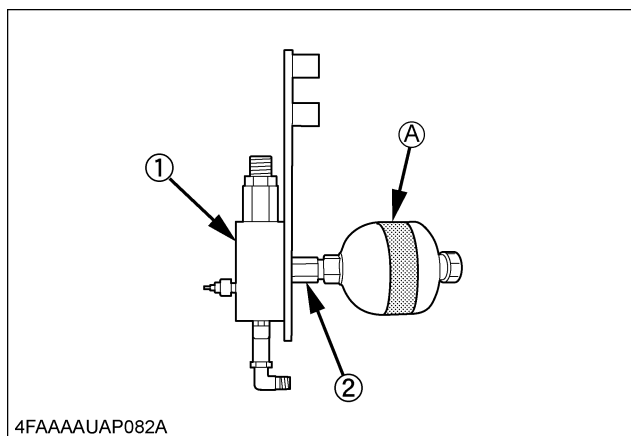

(1) Accumulator assy (RH)

(A) Rubber

(2) Adapter assy