

11.2 Transmission inner structure and name of parts B6000E

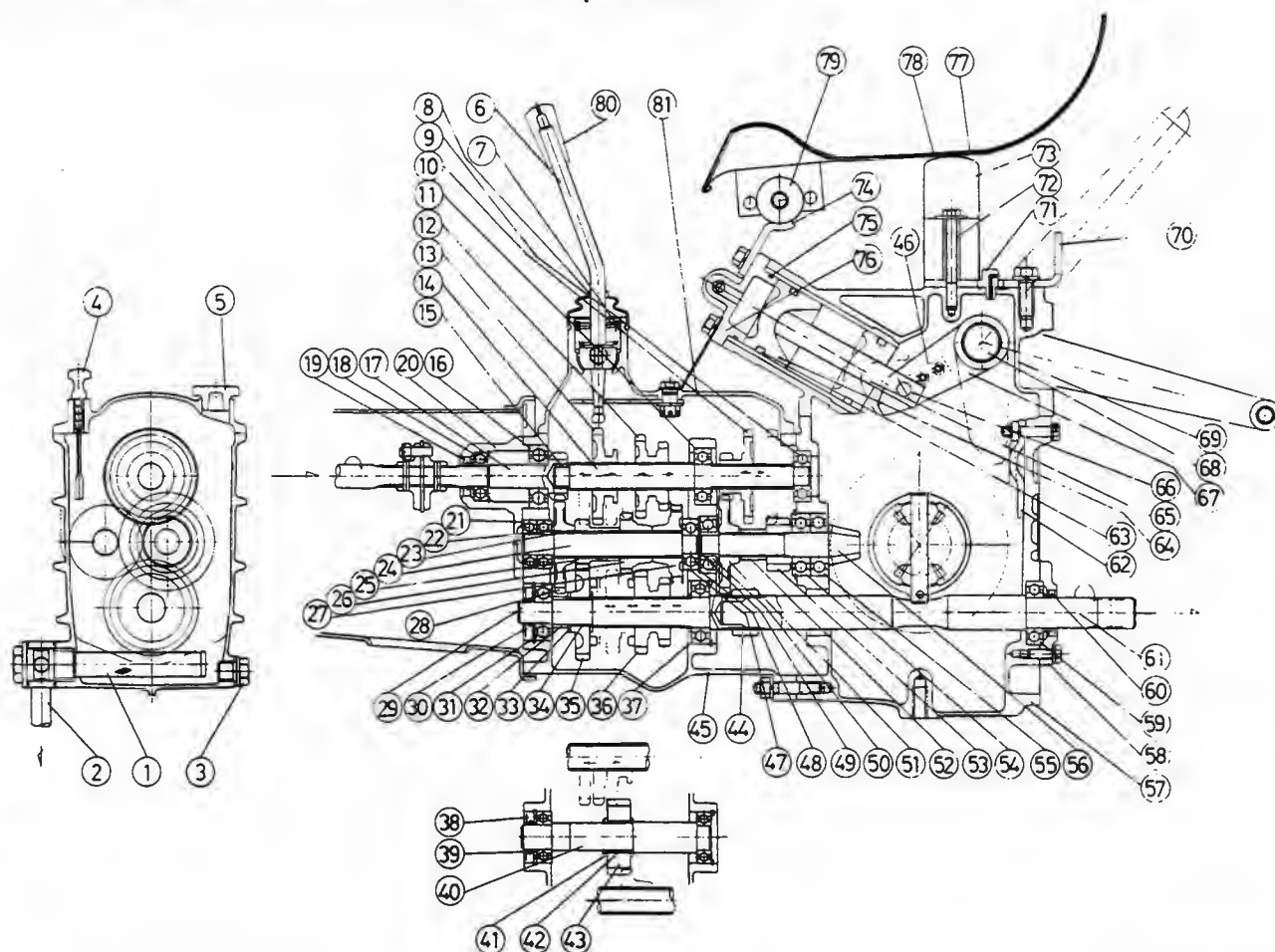

- ① FILTER, oil
- ② PIPE
- ③ PLUG
- ④ GAUGE, oil
- ⑤ CAP
- ⑥ LEVER, main s—change
- ⑦ SPRING
- ⑧ COVER
- ⑨ BEARING, ball
- ⑩ GEAR, 13—28
- ⑪ BEARING, ball
- ⑫ GEAR, 20—25
- ⑬ GEAR, 29
- ⑭ SHAFT, 4th
- ⑮ BEARING, needle
- ⑯ BEARING, ball
- ⑰ SHAFT, 1st
- ⑱ BEARING, ball
- ⑲ SEAL, oil
- ⑳ COVER, 1st shaft

- ㉑ BEARING, ball
- ㉒ COLLAR
- ㉓ COLLAR
- ㉔ SHAFT, 2nd
- ㉕ GEAR, 14
- ㉖ GEAR, 18
- ㉗ GEAR, 23
- ㉘ GEAR, 30
- ㉙ SHAFT, 3rd
- ㉚ SEAL, oil
- ㉛ BEARING, ball
- ㉜ COLLAR
- ㉝ COLLAR, thrust 2
- ㉞ BUSH
- ㉟ GEAR, 29
- ㊱ GEAR, 20—25
- ㊲ BEARING, ball
- ㊳ SEAL, oil
- ㊴ BEARING, ball
- ㊵ SHAFT, reverse

- ㊶ COLLAR, 1st shaft A
- ㊷ BUSH
- ㊸ GEAR, 22
- ㊹ BOSS, spline
- ㊺ CASE, transmission
- ㊻ WASHER, lock
- ㊼ BEARING, ball
- ㊽ COLLAR
- ㊾ BUSH
- ㊿ BEARING, ball
- ① GEAR, 30
- ② COLLAR
- ③ GEAR, 15
- ④ BEARING, ball
- ⑤ BEARING, ball
- ⑥ PINION, spiral bevel gear
- ⑦ CASE, diff gear
- ⑧ COVER, 5th shaft
- ⑨ BEARING, ball
- ⑩ SEAL, oil

- ⑪ SHAFT, 5th
- ⑫ PLATE
- ⑬ O RING
- ⑭ PISTON, oil pressure
- ⑮ ROD, oil pressure piston
- ⑯ PIN, arm
- ⑰ ARM, oil pressure
- ⑱ SHAFT, oil pressure arm
- ⑲ COVER, case REAR
- ㉑ WASHER
- ㉒ BREATHER
- ㉓ COLLAR
- ㉔ SUPPORT, seat rear
- ㉕ SUPPORT, seat front
- ㉖ O RING
- ㉗ CAP, cylinder
- ㉘ SEAT
- ㉙ COVER, seat
- ㉚ CUSHION
- ㉛ GRIP, lever
- ㉜ COVER, case FRONT