

EVERY 400 HOURS

■ Changing Transmission Fluid



WARNING

To avoid personal injury or death:

- Allow engine to cool down sufficiently, oil can be hot and can burn.

1. To drain the used oil, remove the drain plug at the bottom of the transmission case and drain the oil completely into the oil pan.
2. After draining reinstall the drain plug.
3. Fill with new KUBOTA SUPER UDT fluid up to the upper limit on the dipstick.
(See "LUBRICANTS, FUEL AND COOLANT" in "MAINTENANCE" section and "DAILY CHECK" in "PERIODIC SERVICE" section.)
4. After running the engine for a few minutes, stop it and check the oil level again; add oil to prescribed level.
5. Properly dispose of used oil.

Oil capacity	15 L (4.0 U.S.gals.)
--------------	----------------------

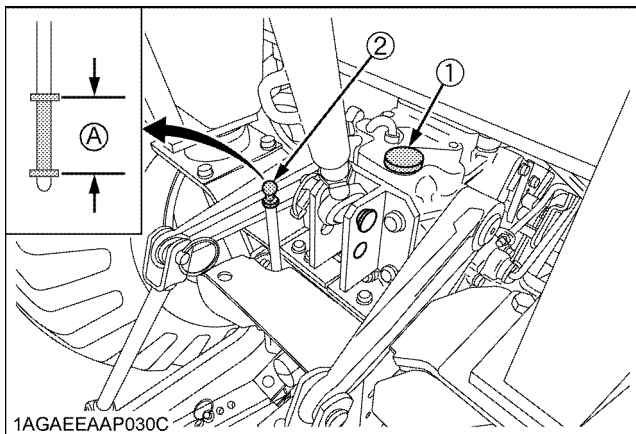

- (1) Oil inlet (A) Oil level is acceptable within this range
(2) Dipstick

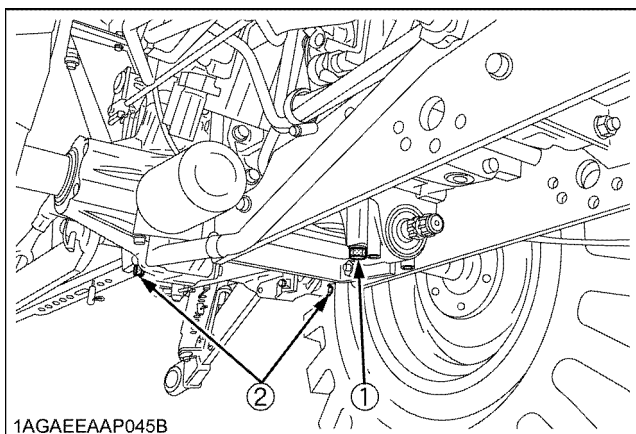

- (1) Drain plug
(2) Drain plugs (Both sides)

IMPORTANT :

- If the 3-point hitch can not be raised by setting the hydraulic control lever to the UP position after long term storage or when changing the transmission oil, turn steering wheel to the right and left several times to bleed air from the system.
- Do not operate the tractor immediately after changing the transmission fluid.

■ Replacing Transmission Oil Filter



WARNING

To avoid personal injury or death:

- Be sure to stop the engine before changing the oil filter cartridge.
- Allow engine to cool down sufficiently, oil can be hot and can burn.

1. Remove the drain plugs at the bottom of the transmission case and drain the oil completely into the oil pan.
2. After draining reinstall the drain plugs.

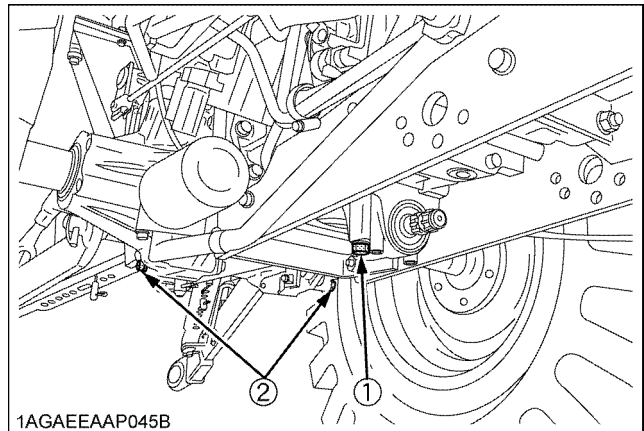

- (1) Drain plug
(2) Drain plugs (Both sides)

3. Remove the oil filter.

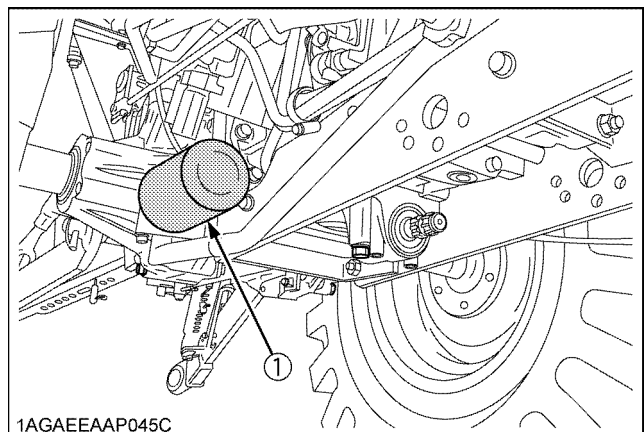

- (1) Transmission oil filter