

# M6800SDT-CAB -> HYDRAULIC SYSTEM -> J13500 HYDRAULIC PUMP [COMPONENT PARTS] ## M6800SDT-CAB

Update Date: 10/16/2015, Printing Date: 05/16/2017

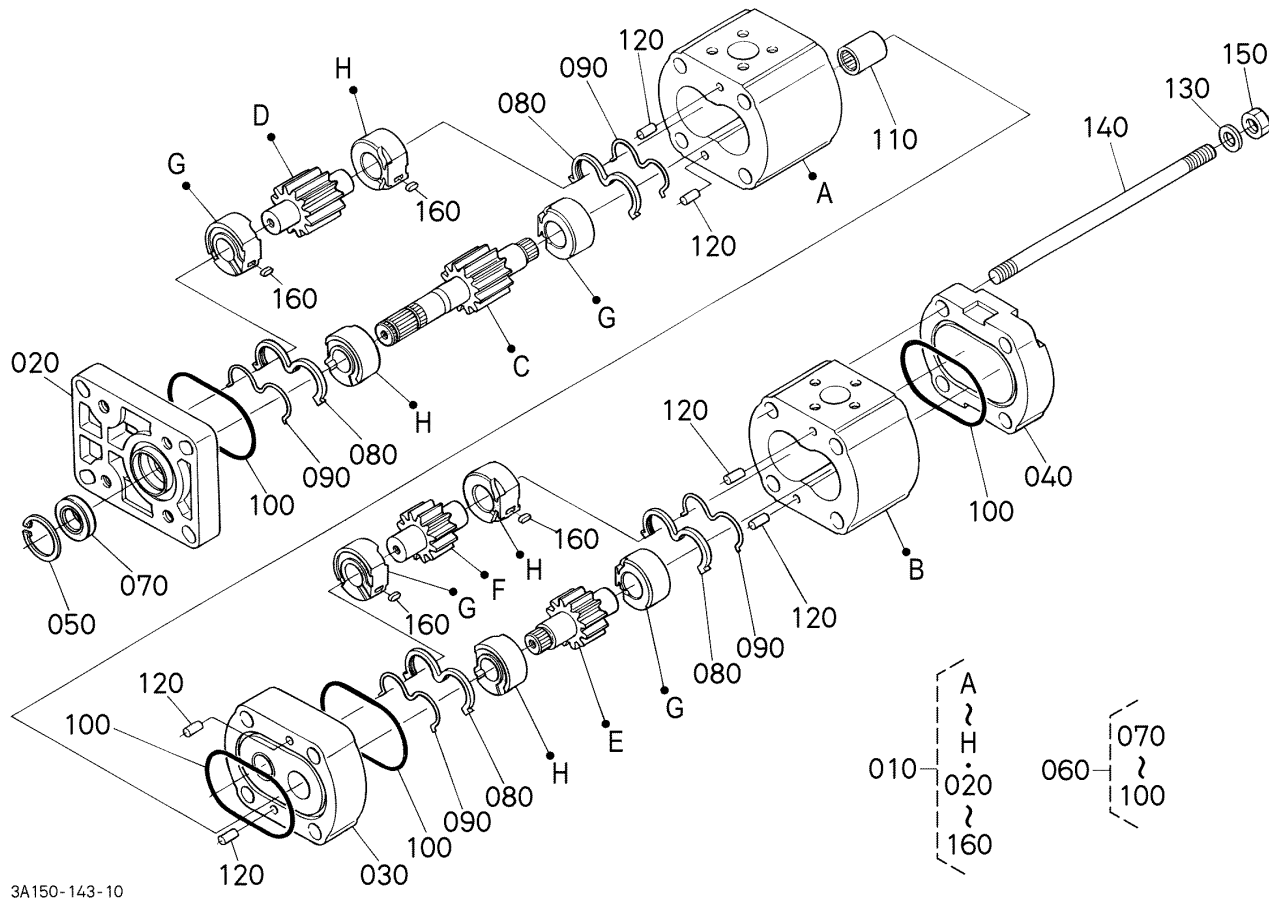

# M6800SDT-CAB -> HYDRAULIC SYSTEM -> J13500 HYDRAULIC PUMP [COMPONENT PARTS] ## M6800SDT-CAB

Update Date: 10/16/2015, Printing Date: 05/16/2017

Interchangeable =, Not Interchangeable NI, New for Old >>, Old for New <<

No	Part Number	Part Name	Qty	RoundUp	IC	S/N	Remarks	Kg
010	3A111-82202	PUMP,HYDRAULIC	1			<=64219		10.12
010	3A111-82204	PUMP,HYDRAULIC	1		>>	>=64220		10.12
020	68721-72210	FLANGE	1					0.99
030	33960-12860	FLANGE	1					1.1
040	68741-72230	COVER	1					0.858
050	68051-91850	RING,SNAP	1					0.0022
060	35890-12970	SEAL,KIT	1					0.011
070	36330-82320	SEAL,OIL	1					0.022
080	35430-12870	ELEMENT,SEAL	4					0.0066
090	68051-91880	ELEMENT,BACK UP	4					0.0022

M6800SDT-CAB -> HYDRAULIC SYSTEM -> J13500 HYDRAULIC PUMP  
 [COMPONENT PARTS] ## M6800SDT-CAB

Update Date: 10/16/2015, Printing Date: 05/16/2017

Interchangeable =, Not Interchangeable NI, New for Old >>, Old for New <<

No	Part Number	Part Name	Qty	RoundUp	IC	S/N	Remarks	Kg
100	68051-91910	O RING	4					0.0022
110	33960-12870	COUPLING	1					0.0616
120	68271-91240	PIN	6					0.0088
130	68741-72250	WASHER	4					0.0044
140	35592-12940	STUD	4			<=64219		0.264
140	3A111-12940	STUD	4		>>	>=64220		0.253
150	68051-92090	NUT	4					0.022
160	68051-91890	KEY	4					0.0022