

SINGLE HANDLE CONTROL VALVE (OPTIONAL)

- A - BUCKET DUMP
B - BUCKET ROLLBACK
C - BOOM DOWN
D - BOOM UP

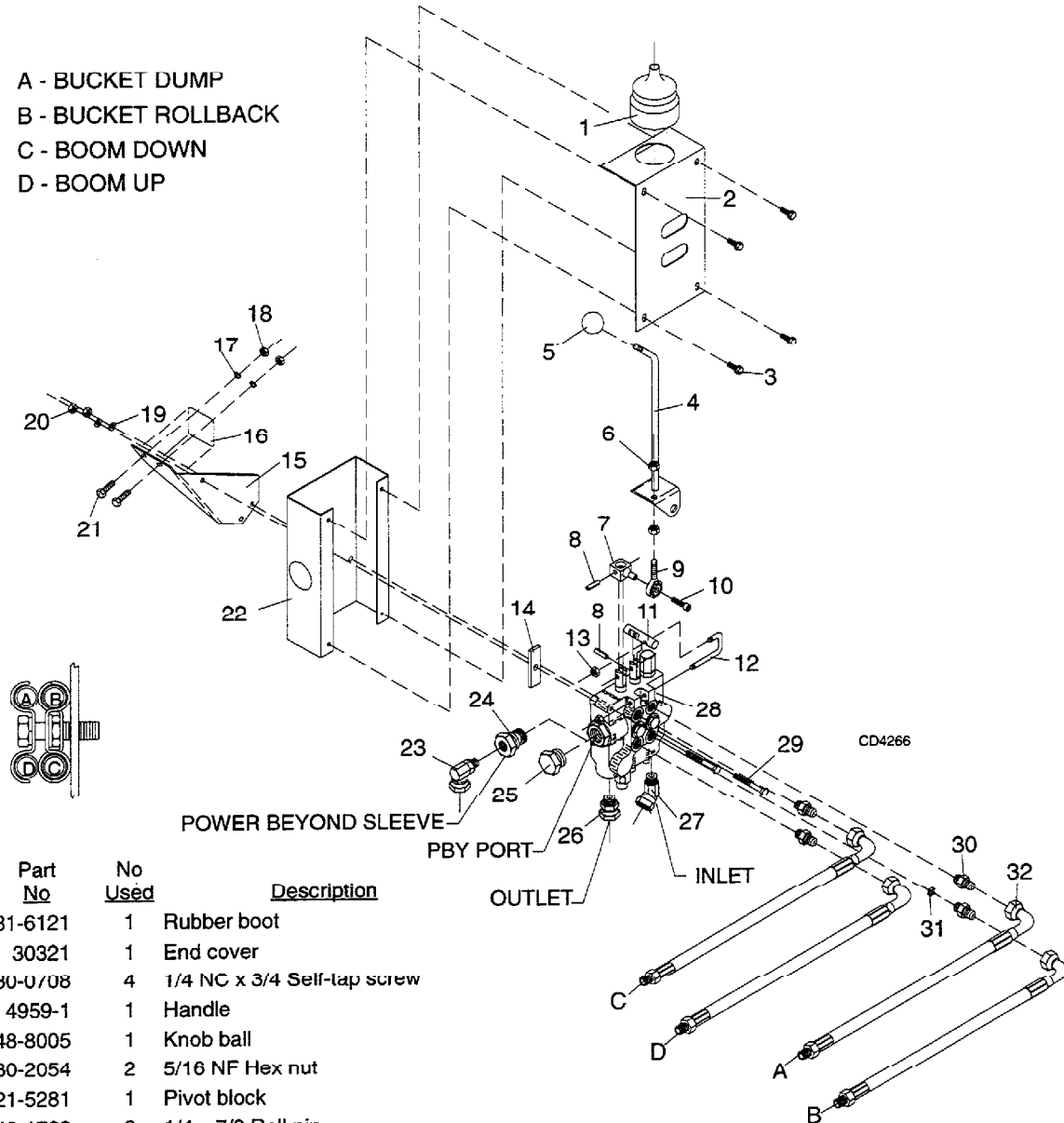

Ref No	Part No	No Used	Description
1	31-6121	1	Rubber boot
2	30321	1	End cover
3	30-U/08	4	1/4 NC x 3/4 Self-tap screw
4	4959-1	1	Handle
5	48-8005	1	Knob ball
6	30-2054	2	5/16 NF Hex nut
7	21-5281	1	Pivot block
8	48-1769	2	1/4 x 7/8 Roll pin
9	48-9089	1	Rod end ball joint
10	30-0067	1	1/4 x 1 Socket head cap screw
11	21-5213	1	Pin
12	21-5214	1	U-Bolt
13	30-2025	2	1/4 NC Self-lock hex nut
14	38140	2	Strap
15	6841-1	1	Valve mounting bracket
16	26-0274	1	Control valve decal
17	30-3150	2	3/8 Lockwasher
18	30-2076	2	3/8 Hex nut
19	30-3050	2	1/4 Lockwasher
20	30-2026	2	1/4 NC Hex nut
21	30-0152	2	3/8 x 1 Cap screw
22	30320	2	Valve cover
23	31-3043	2	90° Elbow

Ref No	Part No	No Used	Description
24	34-6083	1	Power beyond sleeve
25	31-0012	1	Cap plug
26	31-5050	1	Straight adapter
27	31-3047	1	45° Adjustable female pipe swivel
28	34-6081	1	Model 145 Valve
	-or-	-or-	
28	34-6100	1	Model 155/165 Valve
29	30-0068	2	1/4 NC x 2-1/4 Cap screw
30	31-5044	4	Straight adapter
31	34-6166	1	Plate orifice (145 only)
32	36-0214	4	Hose (145 only)
	-or-	-or-	
32	36-0070	4	Hose (155/165)