

L3250DT -> ENGINE -> T01600 GEAR CASE ## L3250DT

Update Date: 09/24/2017, Printing Date: 01/16/2018

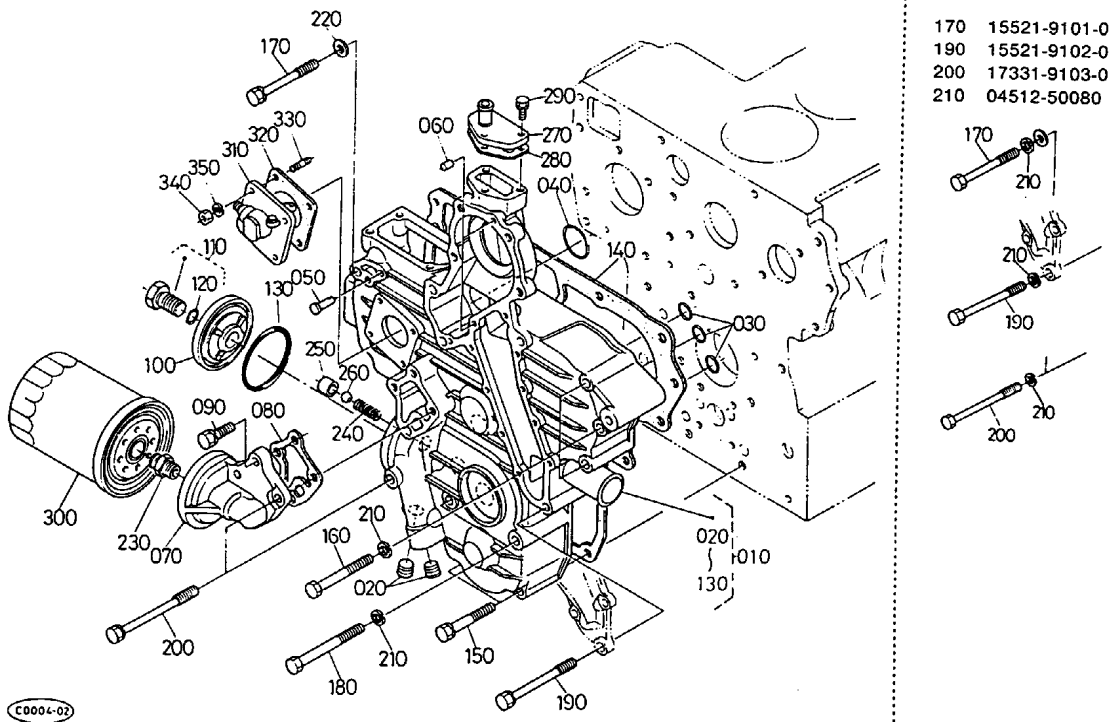

L3250DT -> ENGINE -> T01600 GEAR CASE ## L3250DT

Update Date: 09/24/2017, Printing Date: 01/16/2018

Interchangeable =, Not Interchangeable NI, New for Old >>, Old for New <<

No	Part Number	Part Name	Qty	RoundUp	IC	S/N	Remarks	Kg
010	17331-04020	COMP.CASE GEAR	1					0.0
020	17331-96040	PLUG	2					0.011
030	04811-00150	O-RING	3					0.0022
040	04811-00360	RING	1					0.0044
050	15221-56280	PIN START SPRING	1					0.0132
060	05012-00612	PIN, STRAIGHT	2					0.0066
070	17331-32610	SUPPORT,OIL FILTER	1					0.605
080	17331-32620	GASKET	1					0.0
090	01123-50825	BOLT,SEMS	3					0.0286
100	17331-32880	COVER	1					0.165
110	17331-32910	BOLT,COMP	1					0.154

L3250DT -> ENGINE -> T01600 GEAR CASE ## L3250DT

Update Date: 09/24/2017, Printing Date: 01/16/2018

Interchangeable =, Not Interchangeable NI, New for Old >>, Old for New <<

No	Part Number	Part Name	Qty	RoundUp	IC	S/N	Remarks	Kg
120	04811-00150	O-RING	1					0.0022
130	19202-96830	O RING	1					0.022
140	17331-04130	GASKET GEAR CASE	1					0.0
150	01123-50860	BOLT,SEMS	3					0.044
160	01153-50870	HEX.BOLT	3					0.0572
170	17367-91010	BOLT	2					0.011
180	01153-50880	HEX.BOLT	2					0.066
190	17367-91020	BOLT	3					0.077
200	17367-91030	BOLT	2					0.0836
210	04512-50080	WASHER,SPRING LOCK	5					0.0044
220	04012-50080	WASHER,PLAIN	1					0.0022
230	15521-32290	PIPE JOINT	1					0.11
240	15241-36950	SPRING	1					0.0088
250	15521-36930	SEAT,VALVE	1					0.033
260	07715-03213	BALL	1					0.0088
270	15521-73320	FLANGE,WATER RETURN	1					0.088
280	15521-73330	GASKET	1					0.0
290	01023-50620	BOLT,SEMS	3					0.0132
300	15521-32430	CARTRIDGE OIL FILTER	1					0.0
310	38240-34660	ASSY UNIT HOUR METER	1					0.737
320	15221-88130	GASKET,H/METER UNIT	1					0.0
330	15221-88210	BOLT,STUD	4					0.011
340	02056-50060	HEX.NUT	4					0.0044
350	04512-50060	WASHER,SPRING LOCK	4					0.0022